

# WDM<sup>®</sup>

## PUMPS

**AU** Frame Mounted



**AE** Close Coupled

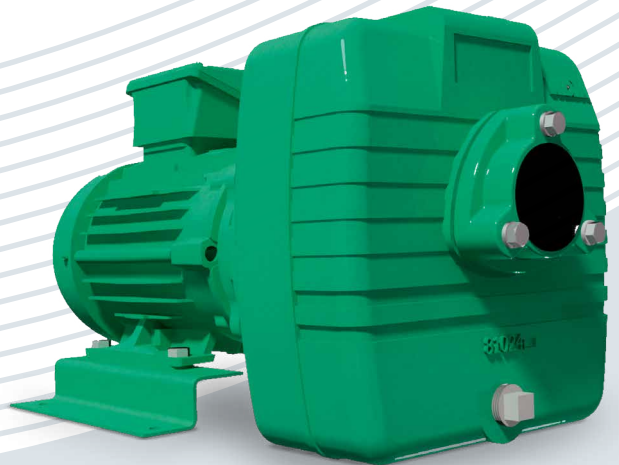

- Flow rates up to 3600 GPM
- Size up to 10" discharge
- Motors up to 75 HP

- Cast iron impeller
- Temperatures up to 158° F (70° C)

- Self priming
- Handling solids up to Ø 2.5"



## Technical Book

Self-Priming Line  
End Suction Pumps

WDM PUMPS



[www.wdmpumps.com](http://www.wdmpumps.com)

## WDM Water Systems

WDM Pumps has expanded its brand as an international manufacturer of fluid handling pumps by consistently meeting and exceeding the needs of our customers.

Continuing a tradition of more than 60 years, WDM Pumps manufactures quality electric and engine driven pumps for diverse commercial and industrial applications. Our continued growth is based on a commitment to high standards for efficient product design, production, sales, and customer support.

Our customers rely on our world-class team of experienced WDM Pumps engineers, technicians, and product application specialists.

WDM offers pump products and related equipment for a wide variety of industries. WDM Pumps manufactured and distributed self priming, flexible coupled, close coupled, vertical multistage, submersible sump and sewage.

WDM Pumps plants are strategically located throughout the Americas.



# INDEX



Pump Family		Content	Pag.
Self-Priming Line	AE AU	Selection Charts	7-8
		Sectional	9-10
		Dimensions	11-14
		Performance Curves	15-37

## Self-Priming Line Close Coupled

### Features:

- Material: Cast iron
- Suction: Up to 6" NPT
- Discharge: Up to 6" NPT
- Impeller: Cast iron. Dynamically balanced
- Mechanical seal: Ceramic / Carbon / Buna-N
- Motor: Single-phase up to 10 HP  
Three-phase up to 25 HP.

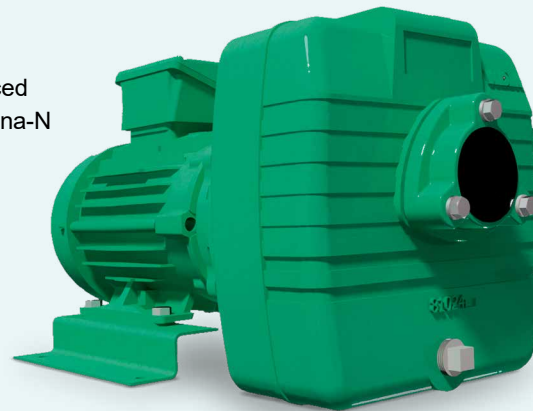

### Benefits:

- Self Priming
- Quick delivery
- Easy set up & installation
- Low and easy maintenance
- Long service life
- Wide range of sizes
- Solid handling

### Nomenclature:

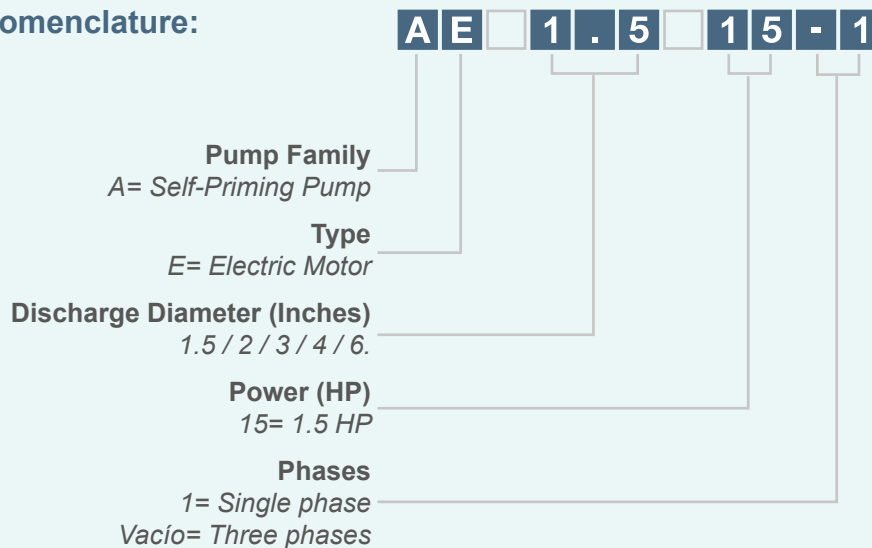



## Self-Priming Line Frame Mounted

### Features

- Material: Cast Iron
- Suction: Up to 10"
- Discharge: Up to 10"
- Impeller: Cast Iron. Dynamically balanced
- Mechanical Seal: Ceramic / Carbon / Buna-N.

### Benefits

- Self Priming
- Quick Delivery
- Easy Set up & Installation
- Low and Easy Maintenance
- Long Service Life
- Variety of Sizes
- Solid Handling



### Nomenclature:

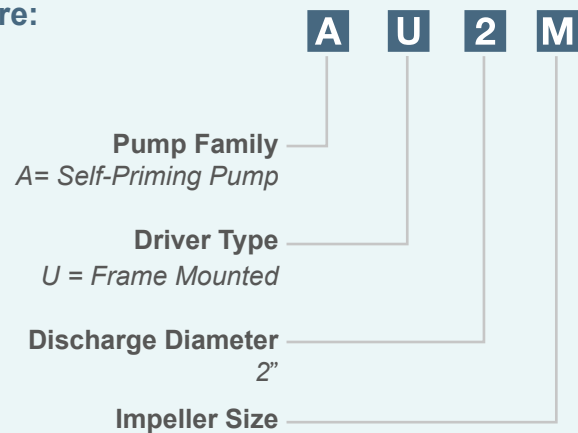

2 poles (3600 rpm)

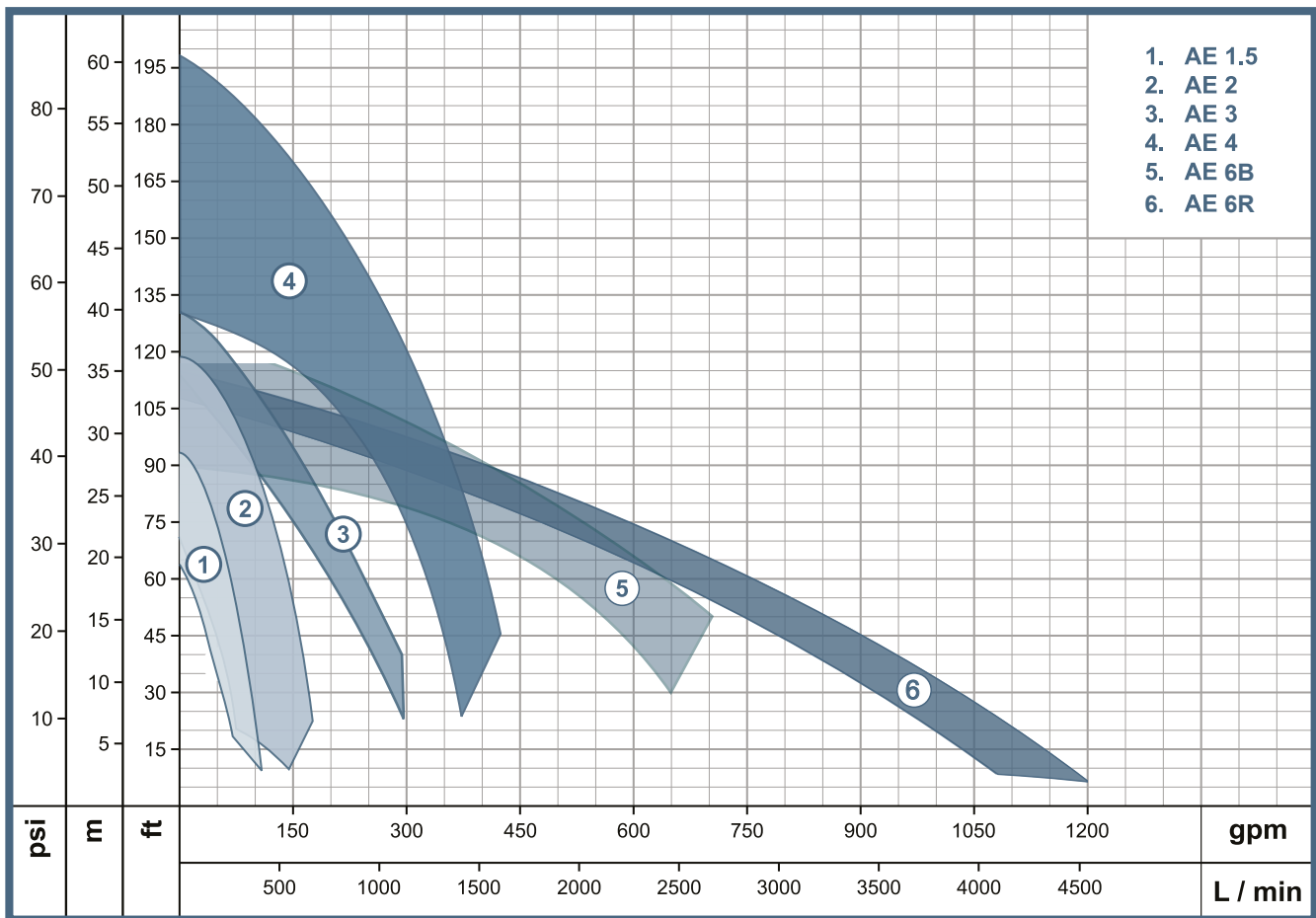

# Selection Charts AU Series

Self-Priming Line  
Cast Iron  
Frame Mounted  
Pumps



www.wdmpumps.com

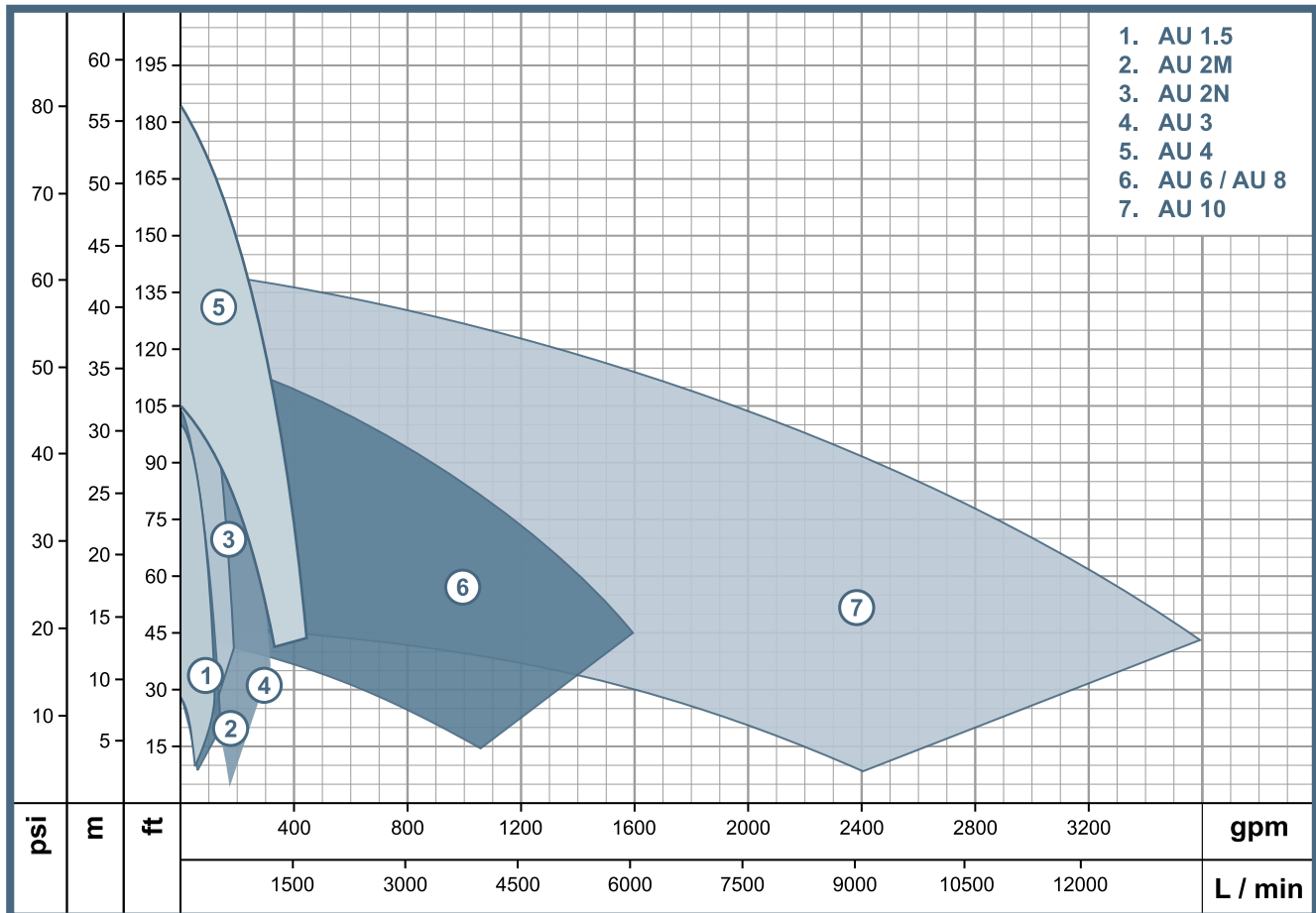

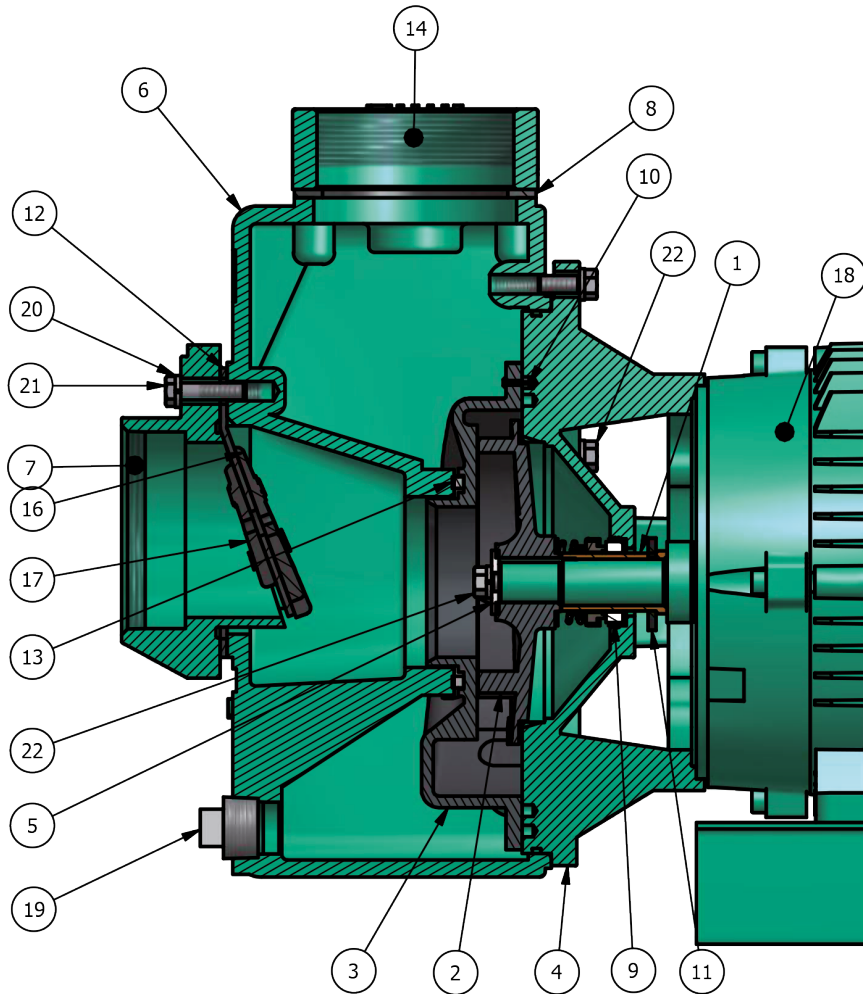

ITEM	QTY	DESCRIPTION	MATERIAL
1	1	SHAFT SLEEVE	STAINLESS STEEL AISI 304
2	1	IMPELLER	CAST IRON ASTM A48
3	1	VOLUTE	CAST IRON ASTM A48
4	1	INTERMEDIATE COUPLING	CAST IRON ASTM A48
5	1	WASHER	STAINLESS STEEL AISI 304
6	1	CASING	CAST IRON ASTM A48
7	1	SUCTION FLANGE	CAST IRON ASTM A48
8	1	GASKET, DISCHARGE	STANDARD PAPER GASKET
9	1	MECHANICAL SEAL	CARBON / CERAMIC / BUNA
10	2	PIN, VOLUTE	STAINLESS STEEL AISI 304
11	1	SLINGER	BUNA

ITEM	QTY	DESCRIPTION	MATERIAL
12	1	NEOPRENE GASKET	NEOPRENE
13	1	GASKET, VOLUTE	RUBBER
14	1	DISCHARGE FLANGE	IRON ASTM A48
15	1	BASE	CARBON STEEL
16	1	BIG WEIGHT	CAST IRON ASTM A48
17	1	SMALL WEIGHT	CAST IRON ASTM A48
18	1	MOTOR	CHECK INFO WITH SUPPLIER
19	2	PIPE PLUG	CARBON STEEL
20	13	LOCK WASHER	CARBON STEEL
21	3	BOLT	CARBON STEEL
22	6	BOLT	CARBON STEEL

# Sectional AU Series

Self-Priming Line  
Cast Iron  
Frame Mounted  
Pumps



www.wdmpumps.com

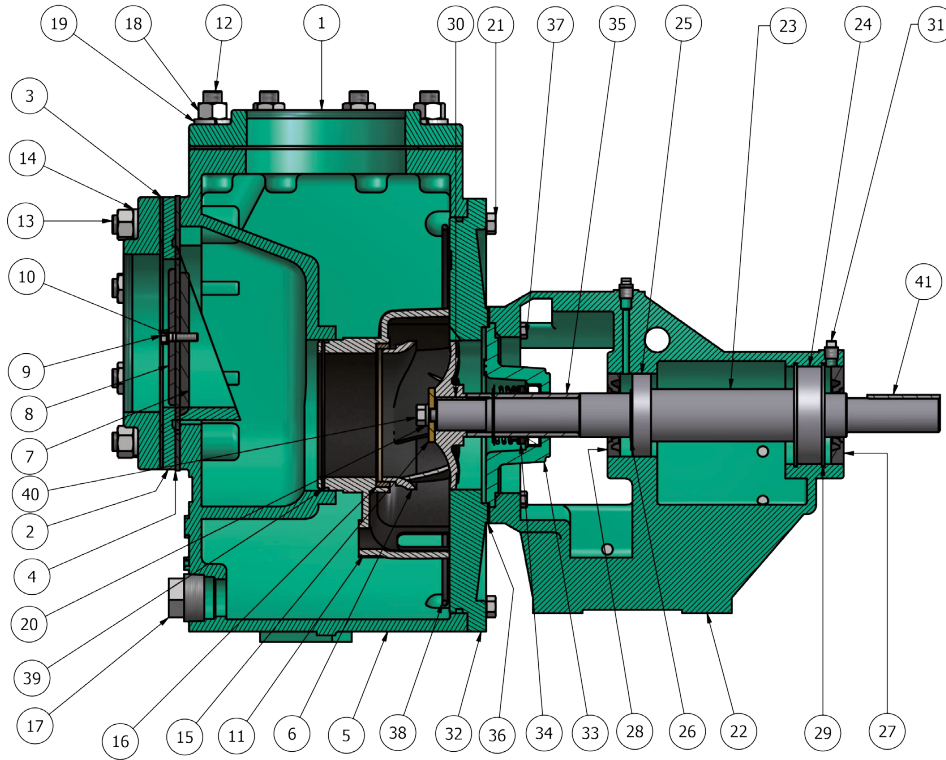

ITEM	QTY	DESCRIPTION	MATERIAL
1	1	DISCHARGE FLANGE	CAST IRON ASTM A48
2	1	SUCTION FLANGE	CAST IRON ASTM A48
3	2	SUCTION FLANGE GASKET	NEOPRENE
4	1	NEOPRENE GASKET	NEOPRENE
5	1	CASING	CAST IRON ASTM A48
6	1	IMPELLER	CAST IRON ASTM A48
7	1	BIG WEIGHT	CAST IRON ASTM A48
8	1	SMALL WEIGHT	CAST IRON ASTM A48
9	1	BOLT	CARBON STEEL
10	1	LOCK WASHER	CARBON STEEL
11	1	VOLUTE	CAST IRON ASTM A48
12	8	STUD	CARBON STEEL
13	8	STUD	CARBON STEEL
14	8	LOCK WASHER	CARBON STEEL
15	1	LOCK WASHER	STAINLESS STEEL AISI 304
16	1	VOLUTE GASKET	RUBBER
17	2	PIPE PLUG	CARBON STEEL
18	16	NUT	CARBON STEEL
19	11	LOCK WASHER	CARBON STEEL
20	9	LOCK WASHER	STAINLESS STEEL AISI 304
21	8	BOLT	CARBON STEEL

ITEM	QTY	DESCRIPTION	MATERIAL
22	1	BEARING BRACKET	CAST IRON ASTM A48
23	4	SHAFT	STEEL ASTM 4140
24	1	BEARING OUTBOARD	CARBON STEEL
25	1	BEARING INBOARD	CARBON STEEL
26	4	SNAP RING	CARBON STEEL
27	1	LIP SEAL	NITRILE RUBBER
28	1	LIP SEAL	NITRILE RUBBER
29	2	SNAP RING	CARBON STEEL
30	1	KEY IMPELLER	CARBON STEEL
31	13	GREASE PLUG	CARBON STEEL
32	1	BACK PLATE	CAST IRON ASTM A48
33	1	SEAL HOUSING	CAST IRON ASTM A48
34	1	MECHANICAL SEAL	CARBON/CERAMIC/BUNA
35	1	SHAFT SLEEVE	STAINLESS STEEL AISI 304
36	1	GASKET BACK PLATE	STANDARD PAPER GASKET
37	6	BOLT	CARBON STEEL
38	1	O-RING	NITRILE RUBBER
39	1	O-RING	NITRILE RUBBER
40	1	BOLT	STAINLESS STEEL AISI 304
41	1	KEY COUPLING	CARBON STEEL

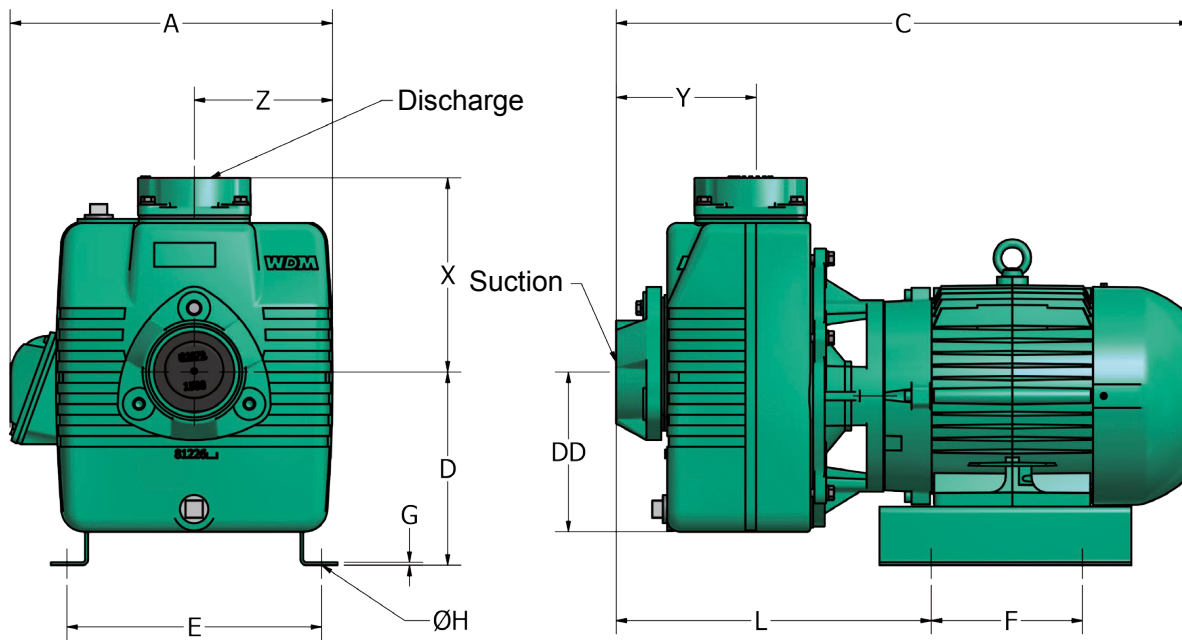

Dimensions (inches)																
Model	Ref.	A	c	D	DD	E	F	G	H	L	X	Y	Z	Frame	Suc	Des
AE 1.5 7-1	1D0046	7 5/8"	18 1/16"	9 5/16"	8 7/16"	2 1/4"	4 3/4"	1/8"	7/16"	9 1/2"	1 1/2"	5 1/2"	3 13/16"	56J	1 1/2"	1 1/2"
AE 1.5 7	1D0380	7 5/8"	18 1/16"	9 5/16"	8 7/16"	2 1/4"	4 3/4"	1/8"	7/16"	9 1/2"	1 1/2"	5 1/2"	3 13/16"	56J	1 1/2"	1 1/2"
AE 1.5 10-1	1D0047	7 5/8"	18 13/16"	9 5/16"	8 7/16"	2 1/4"	4 3/4"	1/8"	7/16"	9 1/2"	1 1/2"	5 1/2"	3 13/16"	56J	1 1/2"	1 1/2"
AE 1.5 10	1D0381	7 5/8"	18 13/16"	9 5/16"	8 7/16"	2 1/4"	4 3/4"	1/8"	7/16"	9 1/2"	1 1/2"	5 1/2"	3 13/16"	56J	1 1/2"	1 1/2"
AE 1.5 15	1D0382	11 3/8"	19 5/8"	6 1/4"	6 1/8"	9 11/16"	7 1/8"	1/8"	7/16"	9 5/8"	4 3/4"	3 3/16"	5 1/8"	143JM	1 1/2"	1 1/2"
AE 1.5 15-1	1D0027	10 3/16"	17 5/8"	6 1/2"	6 1/8"	4 7/8"	3 11/16"	1/8"	7/16"	7 5/8"	4 3/4"	3 3/16"	5 1/8"	56J	1 1/2"	1 1/2"
AE 1.5 20-1	1D0048	10 3/16"	18"	6 1/2"	6 1/8"	4 7/8"	3 11/16"	1/8"	7/16"	7 5/8"	4 3/4"	3 3/16"	5 1/8"	56J	1 1/2"	1 1/2"
AE 1.5 20	1D0500	11 3/8"	19 5/8"	6 1/4"	6 1/8"	9 11/16"	7 1/8"	1/8"	7/16"	9 5/8"	4 3/4"	3 3/16"	5 1/8"	145JM	1 1/2"	1 1/2"
AE 2 20-1	1D0087	7 5/8"	20 3/16"	9 1/4"	8 7/16"	2 5/8"	4 3/4"	1/8"	7/16"	9 3/4"	1 1/2"	5 3/4"	3 13/16"	56J	2"	2"
AE 2 30-1	1D0033	10 5/16"	18 3/8"	6 7/16"	6 1/8"	4 7/8"	3 11/16"	1/8"	7/16"	8 1/16"	4 13/16"	3 13/16"	5 3/16"	56J	2"	2"
AE 2 30	1D0501	11 7/16"	20 1/8"	6 3/16"	6 1/8"	9 11/16"	7 1/8"	1/8"	7/16"	10 1/8"	4 13/16"	3 13/16"	5 3/16"	145JM	2"	2"
AE 2 50	1D0502	11 5/8"	22 1/16"	6 11/16"	6 1/8"	9 13/16"	7"	1/8"	7/16"	10 1/4"	4 13/16"	3 13/16"	5 3/16"	184JM	2"	2"
AE 2 75	1D0383	12 3/4"	22"	7 5/16"	6 1/8"	9 1/4"	7"	1/8"	7/16"	9 3/4"	4 13/16"	3 13/16"	5 3/16"	184JM	2"	2"
AE 3 50-1 TEFC	1D0419/ 1D0419TC	13 13/16"	23 3/4"	8 5/8"	7 1/4"	11"	7"	1/8"	7/16"	12 11/16"	3 3/4"	4 3/16"	5 1/8"	184JM	3"	3"
AE 3 50	1D0385	11 3/4"	23 3/8"	8 1/16"	7 1/4"	9 13/16"	7"	1/8"	7/16"	11 9/16"	3 3/4"	4 3/16"	5 1/8"	184JM	3"	3"
AE 3 75	1D0505	14 1/16"	24 9/16"	8 5/16"	7 1/2"	11"	7 1/8"	1/8"	7/16"	13 1/16"	8 15/16"	5 5/16"	6 1/2"	184JM	3"	3"
AE 4 100	1D0506	15 3/16"	27"	9 1/16"	7 1/2"	12"	7 1/8"	1/8"	7/16"	14 7/8"	9 1/8"	6 5/16"	6 1/2"	215JM	4"	4"
AE 4 150	1D0507	15 3/16"	28 1/2"	8 1/16"	7 1/2"	12"	7"	1/8"	7/16"	16 5/16"	9 1/8"	6 5/16"	6 1/2"	215JM	4"	4"
AE 6R 250	1D0511P	17 3/4"	37"	15 5/8"	-	12"	31 1/2"	-	9/16"	4"	9"	8 1/8"	8 7/8"	256JM	6"	6"
AE 6B 100-1	1D0549	14"	32"	13"	-	10 3/4"	19 5/8"	-	9/16"	6 3/8"	10"	9 1/2"	7"	256JM	6"	6"
AE 6B 100	1D0550	14"	31 1/2"	13"	-	10 3/4"	19 5/8"	-	9/16"	6 3/8"	10"	9 1/2"	7"	256JM	6"	6"
AE 6B 150	1D0551	14"	33"	13"	-	10 3/4"	19 5/8"	-	9/16"	6 3/8"	10"	9 1/2"	7"	256JM	6"	6"

**Dimensions**  
**AU Series**  
 Self-Priming Line  
 Cast Iron  
 Frame Mounted  
 Pumps



www.wdmpumps.com

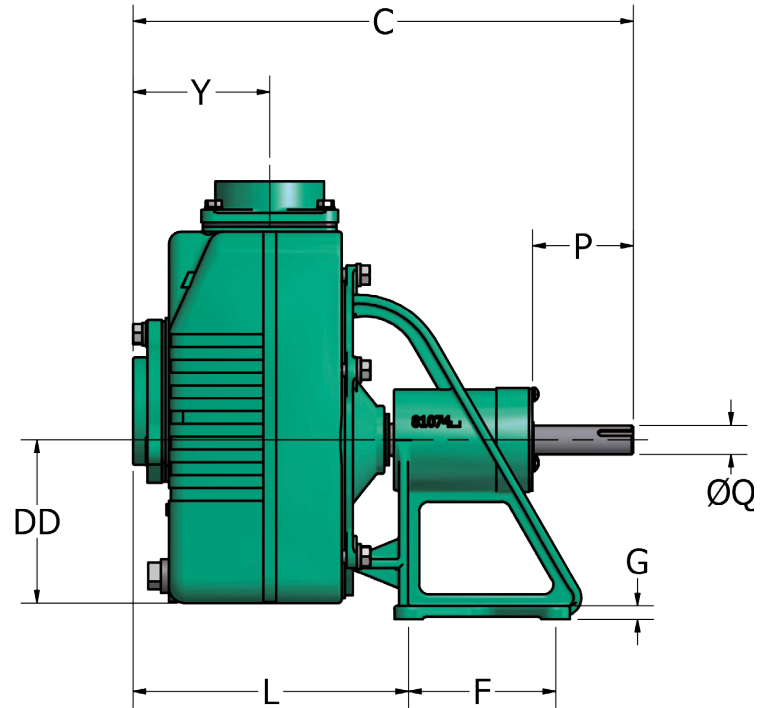
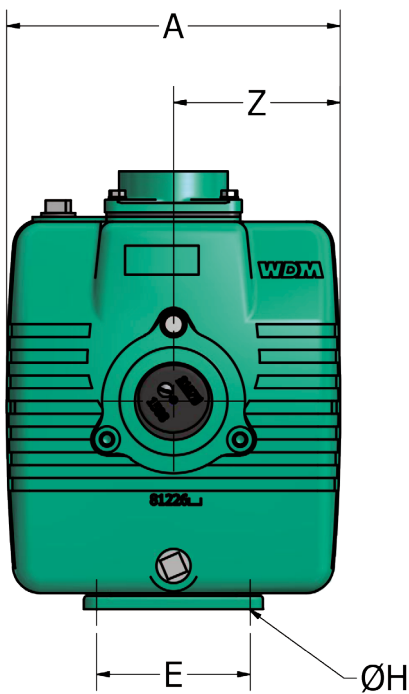

Dimensions (inches)																	
Model	Ref.	A	C	D	DD	E	F	G	H	L	P	Q	X	Y	Z	Suc	Des
AU 1.5	1D0017	10 3/16"	16 1/8"	6 7/16"	6 1/8"	5"	4 11/16"	3/4"	7/16"	8 1/8"	3 7/16"	1 1/8"	4 3/4"	3 3/16"	5 1/8"	1 1/2"	1 1/2"
AU 2M	1D0018	10 5/16"	16 1/2"	6 3/8"	6 1/8"	5"	4 11/16"	3/4"	7/16"	8 1/2"	3 7/16"	1 1/8"	4 13/16"	3 13/16"	5 3/16"	2"	2"
AU 2N	1D0019	10 1/4"	16 1/2"	6 3/8"	6 1/8"	5"	4 11/16"	3/4"	7/16"	8 1/2"	3 7/16"	1 1/8"	4 13/16"	3 13/16"	5 3/16"	3"	3"
AU 3	1D0021	13"	19 3/8"	8 1/8"	7 1/2"	6"	5 3/4"	1/2"	7/16"	10 3/4"	3 15/16"	1 1/8"	8 15/16"	5 5/16"	6 1/2"	3"	3"
AU 4	1D0022	13"	20 9/16"	8 1/8"	7 1/2"	6"	5 3/4"	1/2"	7/16"	11 3/4"	3 15/16"	1 1/8"	9 1/8"	6 5/16"	6 1/2"	4"	4"
AU 6	1D0023	21 9/16"	30 3/8"	17 1/4"	14"	12"	10"	13/16"	3/4"	18"	3 7/8"	1 1/2"	12 5/8"	8 7/8"	10 13/16"	6"	6"
AU 6R	1D0513	17 3/4"	32 13/16"	12 1/2"	12 1/16"	7 3/4"	6"	7/8"	9/16"	17 15/16"	3 7/8"	1 3/8"	9"	8 1/8"	8 7/8"	6"	6"
AU 8	1D0125	21 9/16"	33 11/16"	16 1/16"	12 13/16"	12"	10"	13/16"	3/4"	21 3/8"	3 11/16"	1 1/2"	17"	12 1/4"	10 3/4"	8"	8"
AU 10	1D0024	27 5/16"	38"	19 5/8"	19 1/4"	12"	10"	13/16"	3/4"	27"	3 1/16"	1 1/2"	16 5/16"	17 5/16"	13 5/8"	10"	10"

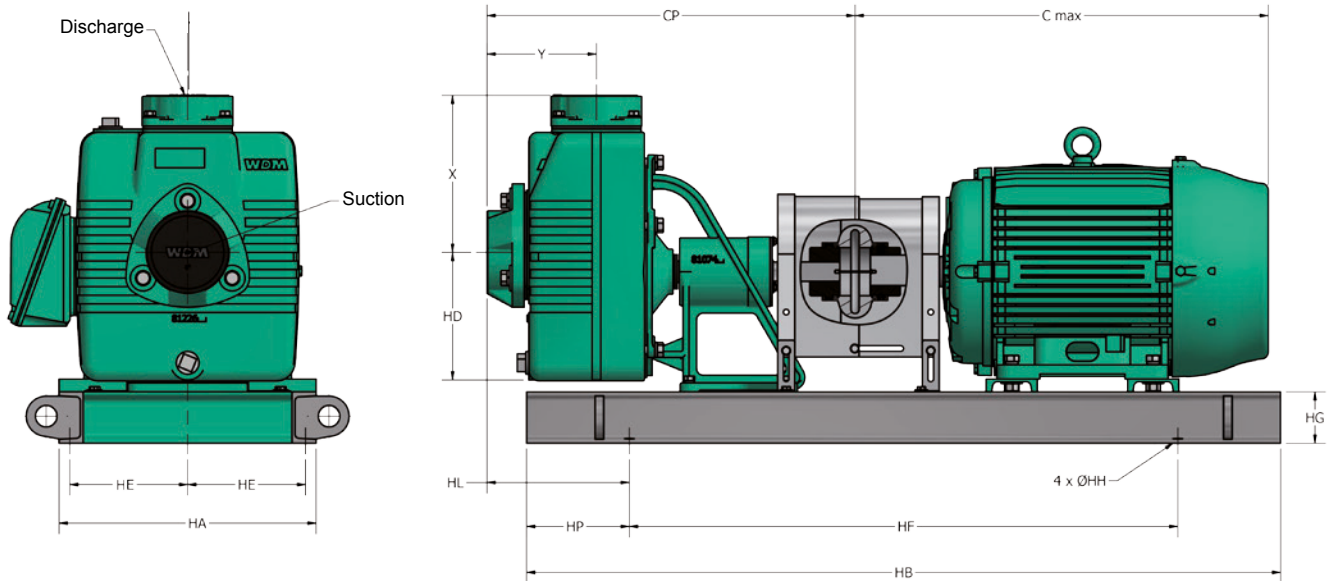

Dimensions (Inches)																		
Ref.	Model	Suc	Desc	Power (HP)	HE	HA	Z	HD	X	Y	CP	C Max	HG	HH	HF	HB	HP	HL
113434	AU 1.5 5-4 WE3	1 1/2	1 1/2	0.5	5.375	12.000	0.000	9.463	4.725	3.187	16.779	13.040	3.000	9/16	25.700	29.700	2.000	2.121
113435	AU 1.5 7.5-4 WE3	1 1/2	1 1/2	0.75	5.375	12.000	0.000	9.463	4.725	3.187	16.779	13.040	3.000	9/16	25.700	29.700	2.000	2.121
113436	AU 1.5 10-4 WE3	1 1/2	1 1/2	1	5.375	12.000	0.000	9.463	4.725	3.187	16.779	13.040	3.000	9/16	25.700	29.700	2.000	2.121
113437	AU 1.5 15-4 WE3	1 1/2	1 1/2	1.5	5.375	12.000	0.000	9.463	4.725	3.187	16.779	14.000	3.000	9/16	25.700	29.700	2.000	2.121
113438	AU 1.5 20 WE3	1 1/2	1 1/2	2	5.375	12.000	0.000	9.463	4.725	3.187	16.779	14.000	3.000	9/16	25.700	29.700	2.000	2.121
113439	AU 1.5 30 WE3	1 1/2	1 1/2	3	5.375	12.000	0.000	9.463	4.725	3.187	16.539	15.407	3.000	9/16	18.000	31.000	6.500	7.446
113440	AU 2M 5-4 WE3	2	2	0.5	5.375	12.000	0.000	9.375	4.789	3.768	17.517	13.356	3.000	9/16	25.700	29.700	2.000	2.500
113441	AU 2M 15-4 WE3	2	2	1.5	5.375	12.000	0.000	9.375	4.789	3.768	17.157	14.314	3.000	9/16	25.700	29.700	2.000	2.500
113442	AU 2M 20 WE3	2	2	2	5.375	12.000	0.000	9.375	4.789	3.768	17.157	14.314	3.000	9/16	25.700	29.700	2.000	2.500
113443	AU 2M 30 WE3	2	2	3	5.375	12.000	0.000	9.375	4.789	3.768	16.917	15.408	3.000	9/16	25.700	29.700	2.000	2.500
113444	AU 2N 5-4 WE3	2	2	0.5	5.375	12.000	0.000	9.375	4.839	3.813	17.203	13.042	3.000	9/16	25.700	29.700	2.000	2.545
113445	AU 2N 15-4 WE3	2	2	1.5	5.375	12.000	0.000	9.375	4.839	3.813	17.203	14.268	3.000	9/16	25.700	29.700	2.000	2.545
113446	AU 2N 20 WE3	2	2	2	5.375	12.000	0.000	9.375	4.839	3.813	17.203	14.268	3.000	9/16	25.700	29.700	2.000	2.500
113406	AU 2N 30 WE3	2	2	3	5.375	12.000	0.000	9.375	4.839	3.813	16.918	15.407	3.000	9/16	18.000	31.000	6.500	7.870
113408	AU 2N 50 WE3	2	2	5	5.375	12.000	0.000	9.375	4.839	3.813	16.963	16.298	3.000	9/16	18.000	31.000	6.500	7.870
113447	AU 3 10-4 WE3	3	3	1	5.880	13.000	0.000	11.120	8.968	5.337	20.188	13.650	3.000	9/16	24.300	32.300	4.000	5.259
113448	AU 3 20-4 WE3	3	3	2	5.880	13.000	0.000	11.120	8.968	5.337	20.188	14.000	3.000	9/16	24.300	32.300	4.000	5.259
113449	AU 3 30-4 WE3	3	3	3	5.880	13.000	0.000	11.120	8.968	5.337	20.188	16.071	3.000	9/16	28.000	35.000	3.500	4.759
113450	AU 3 50 WE3	3	3	5	5.880	13.000	0.000	11.120	8.968	5.337	20.188	16.538	3.000	9/16	28.000	35.000	3.500	4.759
113451	AU 3 75 WE4	3	3	7.5	5.880	13.000	0.000	11.120	8.968	5.337	20.188	18.780	3.000	9/16	29.209	38.209	4.500	5.259

Dimensions (inches)																		
Ref.	Model	Suc	Desc	Power (HP)	HE	HA	Z	HD	X	Y	CP	C Max	HG	HH	HF	HB	HP	HL
113420	AU 4 100-4 WE4	4	4	10	6.875	13.000	0.000	11.126	7.000	6.387	21.238	20.156	3.000	9/17	29.209	38.209	4.500	6.309
113452	AU 4 20-4 WE3	4	4	2	5.880	13.000	0.000	11.126	7.000	6.387	21.238	13.650	3.000	9/16	24.300	32.300	4.000	5.809
113453	AU 4 50-4 WE3	4	4	5	5.880	13.000	0.000	11.126	7.000	6.387	21.238	16.538	3.000	9/16	28.000	35.000	3.500	5.309
113454	AU 4 75-4 WE4	4	4	7.5	5.880	13.000	0.000	11.126	7.000	6.387	21.238	18.780	3.000	9/16	29.209	38.209	4.500	6.309
113455	AU 4 150 WE5	4	4	15	6.880	15.000	0.000	11.126	7.000	6.387	21.478	24.831	3.000	9/16	32.000	44.000	6.000	7.809
113456	AU 6 100-6 WE10	6	6	10	12.313	26.000	0.000	14.000	12.742	8.972	31.350	25.983	6.000	11/16	47.333	57.333	5.000	5.000
113457	AU 6 150-6 WE10	6	6	15	12.313	26.000	0.000	14.000	12.742	8.972	31.364	28.750	6.000	11/16	44.000	60.000	8.000	8.114
113458	AU 6 200-4 WE10	6	6	20	12.313	26.000	0.000	14.000	12.742	8.972	31.350	25.983	6.000	11/16	47.333	57.333	5.000	5.000
113459	AU 6 250-4 WE10	6	6	25	12.313	26.000	0.000	14.000	12.742	8.972	31.364	28.750	6.000	11/16	44.000	60.000	8.000	8.114
113460	AU 6 300-4 WE10	6	6	30	12.313	26.000	0.000	14.000	12.742	8.972	31.364	28.750	6.000	11/16	44.000	60.000	8.000	8.114
113461	AU 6 400-4 WE10	6	6	40	14.313	30.000	0.000	14.000	12.742	8.972	31.364	30.583	6.000	11/16	47.950	61.950	7.000	6.997
113462	AU 6R 50-4 WE4	6	6	5	8.813	15.160	0.000	12.062	9.113	8.510	33.851	16.649	6.000	11/16	36.500	50.500	7.000	7.000
113463	AU 6R 150 WE5	6	6	15	8.813	15.160	0.000	12.062	9.113	8.510	34.081	24.110	6.000	11/16	44.000	58.000	7.000	7.191
113464	AU 6R 250 WE10	6	6	25	8.813	15.160	0.000	12.062	9.113	8.510	34.096	28.827	6.000	11/16	47.000	61.000	7.000	8.923
113465	AU 8 100-6 WE10	8	8	10	12.313	26.000	0.000	12.813	17.018	12.225	34.617	25.983	6.000	11/16	47.333	57.333	5.000	8.267
113466	AU 8 150-6 WE10	8	8	15	12.313	26.000	0.000	12.813	17.018	12.225	34.617	28.827	6.000	11/16	44.000	60.000	8.000	11.444
113467	AU 8 200-4 WE10	8	8	20	12.313	26.000	0.000	12.813	17.018	12.225	34.617	25.983	6.000	11/16	47.333	57.333	5.000	8.267
113468	AU 8 250-4 WE10	8	8	25	12.313	26.000	0.000	12.813	17.018	12.225	34.617	28.827	6.000	11/16	44.000	60.000	8.000	11.444
113469	AU 8 300-4 WE10	8	8	30	12.313	26.000	0.000	12.813	17.018	12.225	34.617	28.751	6.000	11/16	44.000	60.000	8.000	11.368
113432	AU 8 400-4 WE10	8	8	40	14.313	31.500	0.000	12.813	17.018	12.225	34.617	30.593	6.000	11/16	47.950	61.950	7.000	15.675
113470	AU 10 200-6 WE10	10	10	20	14.313	30.000	0.000	19.259	16.406	17.384	40.032	29.431	6.000	11/16	49.800	63.800	7.000	12.663
113430	AU 10 300-4 WE 20	10	10	30	14.313	30.000	0.000	19.259	16.406	17.384	39.332	29.431	6.000	11/16	49.800	63.800	7.000	11.963
113471	AU 10 400-4 WE20	10	10	40	14.313	30.000	0.000	19.259	16.406	17.384	40.032	29.431	6.000	11/16	55.250	69.250	7.000	7.213
113472	AU 10 500-4 WE20	10	10	50	14.313	30.000	0.000	19.259	16.406	17.384	40.032	29.431	6.000	11/16	55.250	69.250	7.000	7.213
113473	AU 10 600-4 WE30	10	10	60	14.313	30.000	0.000	19.259	16.406	17.384	40.032	29.431	6.000	11/16	56.600	70.600	7.000	5.863
113474	AU 10 750-4 WE30	10	10	75	14.313	30.000	0.000	19.259	16.406	17.384	40.032	29.431	6.000	11/16	56.600	70.600	7.000	5.863

Pump Features					
Pump Type	Design		Impeller		
End Suction	Close Coupled		Semi-open (ISO G6.3)		
Stages	Mechanical Seal		Fluid temperature	Ø Solid Handling	
1	5/8" T6		158° F (70° C)	1/4"	
Model	Reference	Ø Suction	Ø Discharge	Ø Impeller	
1	AE 1.5 7-1	1D0046	1 1/2" NPT	1 1/2" NPT	4.785"
2	AE 1.5 7	1D0380	1 1/2" NPT	1 1/2" NPT	4.785"
3	AE 1.5 10-1	1D0047	1 1/2" NPT	1 1/2" NPT	4.785"
4	AE 1.5 10	1D0381	1 1/2" NPT	1 1/2" NPT	4.785"

Motor Features				
Drive		Speed (rpm)	Frequency (Hz)	
Electric		3,600 (nominal)	60	
Power (hp)	Phases	Voltage (V)	Enclosure	Frame
0.75	1	127/230	ODP	NEMA 56J
0.75	3	230/460	TEFC	NEMA 56J
1	1	127/230	ODP	NEMA 56J
1	3	230/460	TEFC	NEMA 56J

### Performance Curve

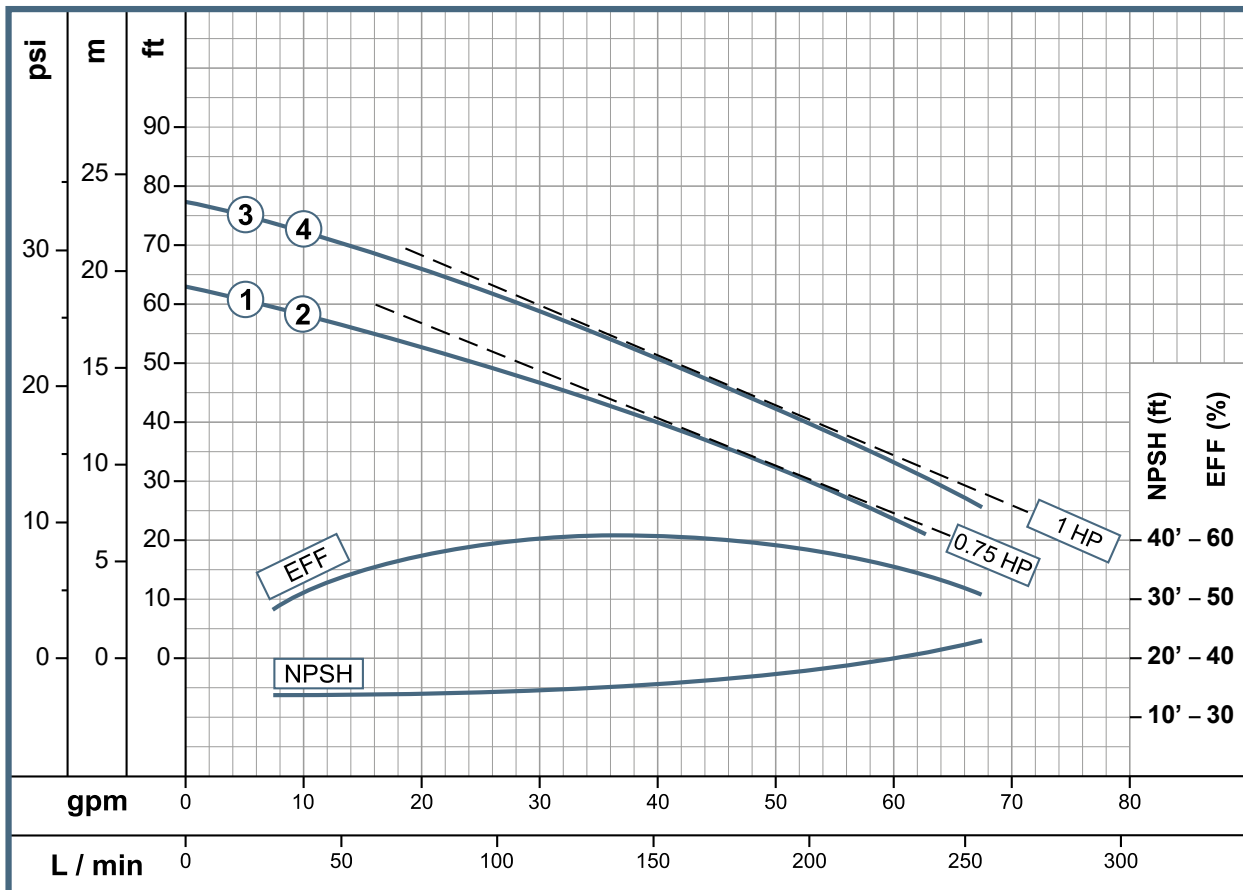

# Self-Priming Line

AE 1.5 15-1  
AE 1.5 15



www.wdmpumps.com

Pump Features				
Pump Type	Design		Impeller	
End Suction	Close Coupled		Semi-open (ISO G6.3)	
Stages	Mechanical Seal		Fluid Temperature	Ø Solid Handling
1	5/8" T6 y 1 1/4" T01		158° F (70° C)	11/16"
Model	Reference	Ø Suction	Ø Discharge	Ø Impeller
1	AE 1.5 15-1	1D0027	1 1/2" NPT	4.875"
2	AE 1.5 15	1D0382	1 1/2" NPT	4.875"

Motor Features				
Drive		Speed (rpm)	Frequency (Hz)	
Electric		3,600 (nominal)	60	
Power (hp)	Phases	Voltage (V)	Enclosure	Frame
1.5	1	127/230	ODP	NEMA 56J
1.5	3	230/460	TEFC	NEMA 56J

## Performance Curve

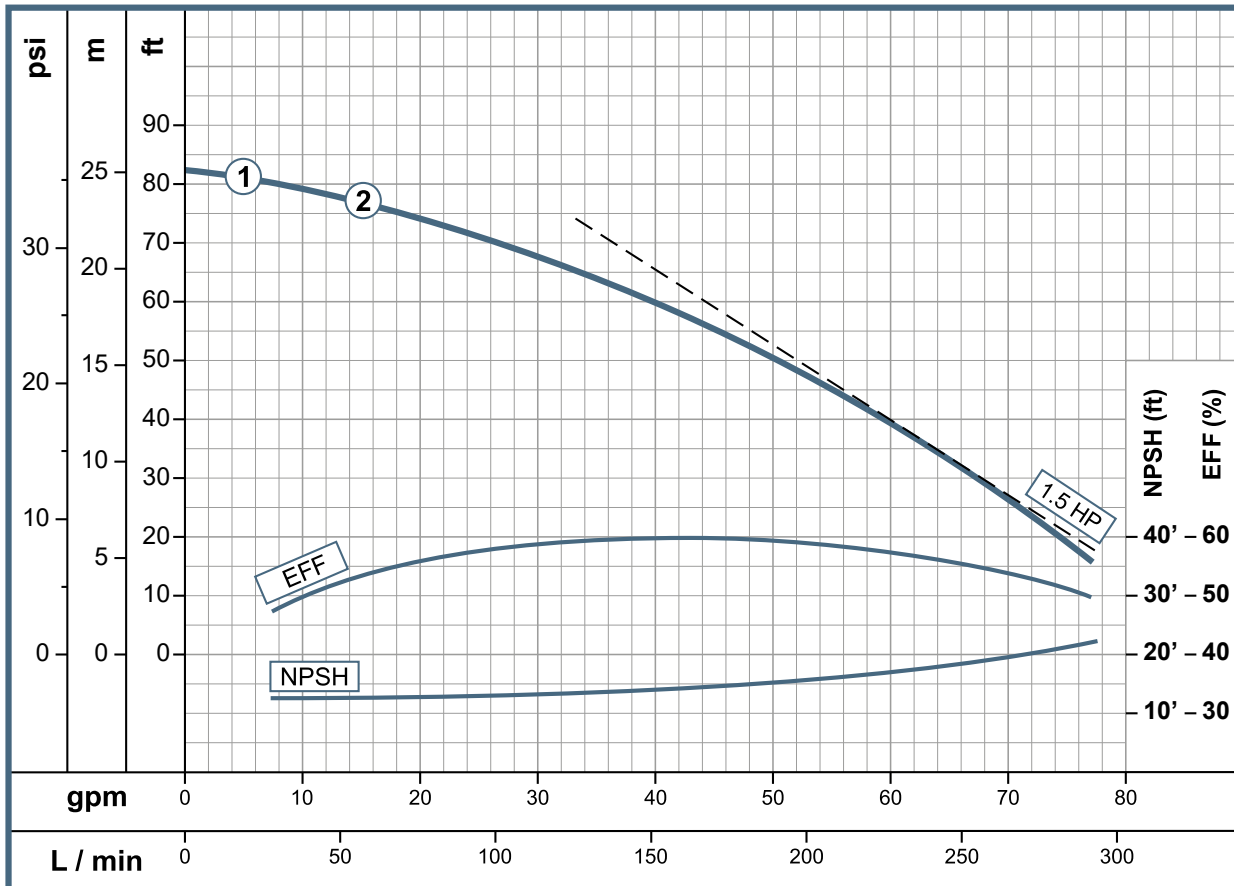

Pump Features				
Pump Type	Design		Impeller	
End Suction	Close Coupled		Semi-open (ISO G6.3)	
Stages	Mechanical Seal		Fluid Temperature	Ø Solid Handling
1	5/8" T6		158° F (70° C)	3/8"
Model	Reference	Ø Suction	Ø Discharge	Ø Impeller
AE 1.5 20-1	1D0048	1 1/2" NPT	1 1/2" NPT	4.785"
AE 1.5 20	1D0500	1 1/2" NPT	1 1/2" NPT	4.785"

Motor Features				
Drive		Speed (rpm)	Frequency (Hz)	
Electric		3,600 (nominal)	60	
Power (hp)	Phases	Voltage (V)	Enclosure	Frame
2	1	127/230	ODP	NEMA 56J
2	3	230/460	TEFC	NEMA 146JM

### Performance Curve

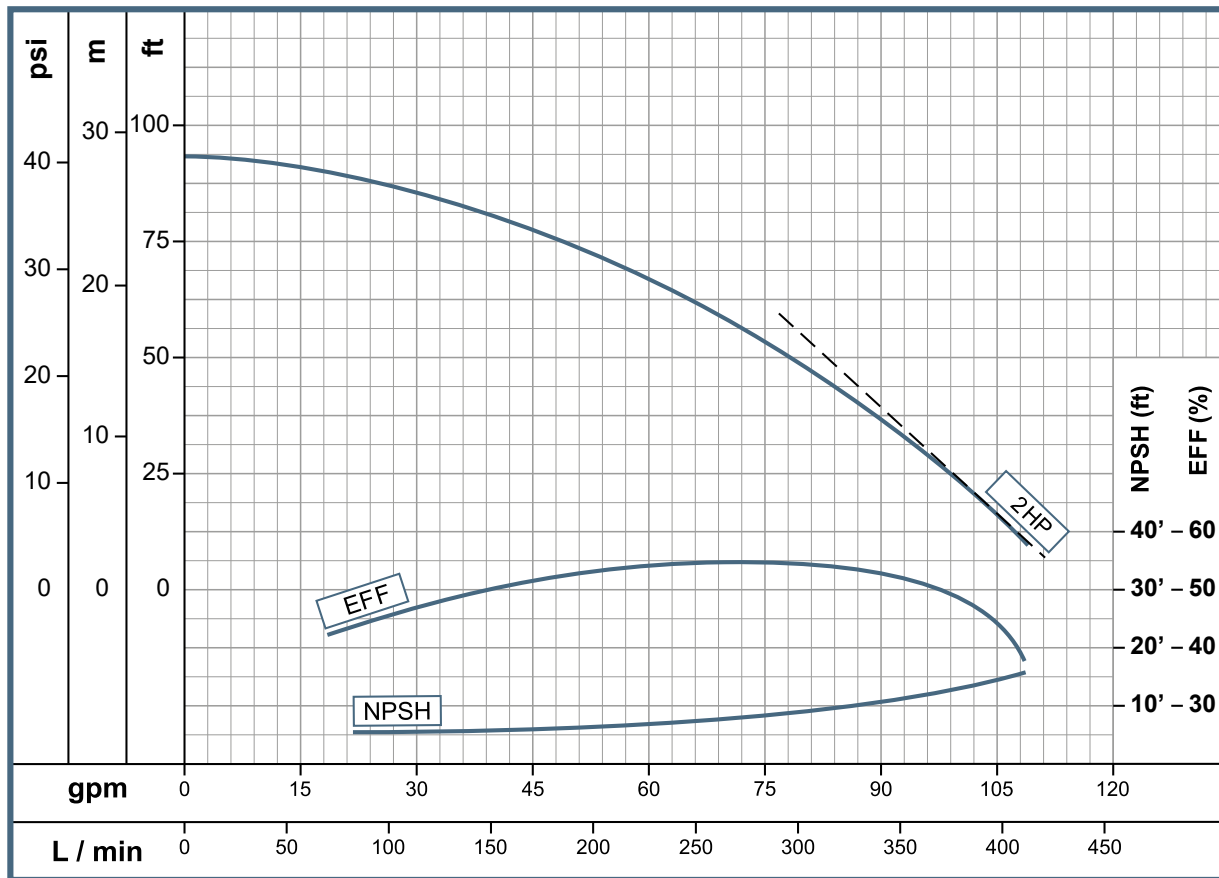

# Self-Priming Line

AE 2 20-1



www.wdmpumps.com

Pump Features				
Pump Type	Design		Impeller	
End Suction	Close Coupled		Semi-open (ISO G6.3)	
Stages	Mechanical Seal		Fluid Temperature	Ø Solid Handling
1	5/8" T6		158° F (70° C)	1/2"
Model	Reference	Ø Suction	Ø Discharge	Ø Impeller
AE 2 20-1	1D0087	2" NPT	2" NPT	4.650"

Motor Features				
Drive		Speed (rpm)	Frequency (Hz)	
Electric		3.600 (nominal)	60	
Power (hp)	Phases	Voltage (V)	Enclosure	Frame
2	1	127/230	ODP	NEMA 56J

## Performance Curve

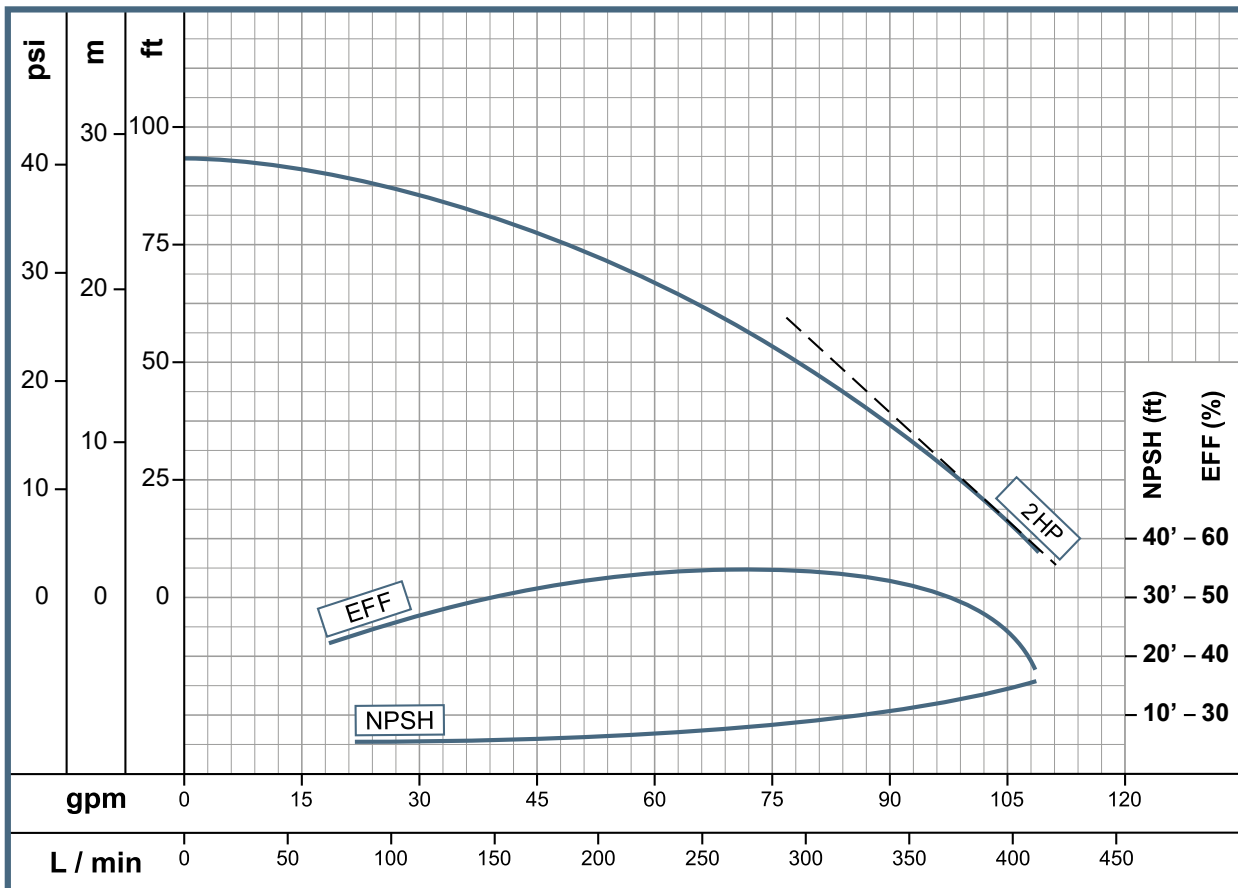

Pump Features				
Pump Type	Design		Impeller	
End Suction	Close Coupled		Semi-open (ISO G6.3)	
Stages	Mechanical Seal		Fluid Temperature	Ø Solid Handling
1	5/8" T6		158° F (70° C)	3/8"
Model	Reference	Ø Suction	Ø Discharge	Ø Impeller
AE 2 30-1	1D0033	2" NPT	2" NPT	4.875"

Motor Features				
Drive		Speed (rpm)	Frequency (Hz)	
Electric		3,600 (nominal)	60	
Power (hp)	Phases	Voltage (V)	Enclosure	Frame
3	1	230	ODP	NEMA 56J

### Performance Curve

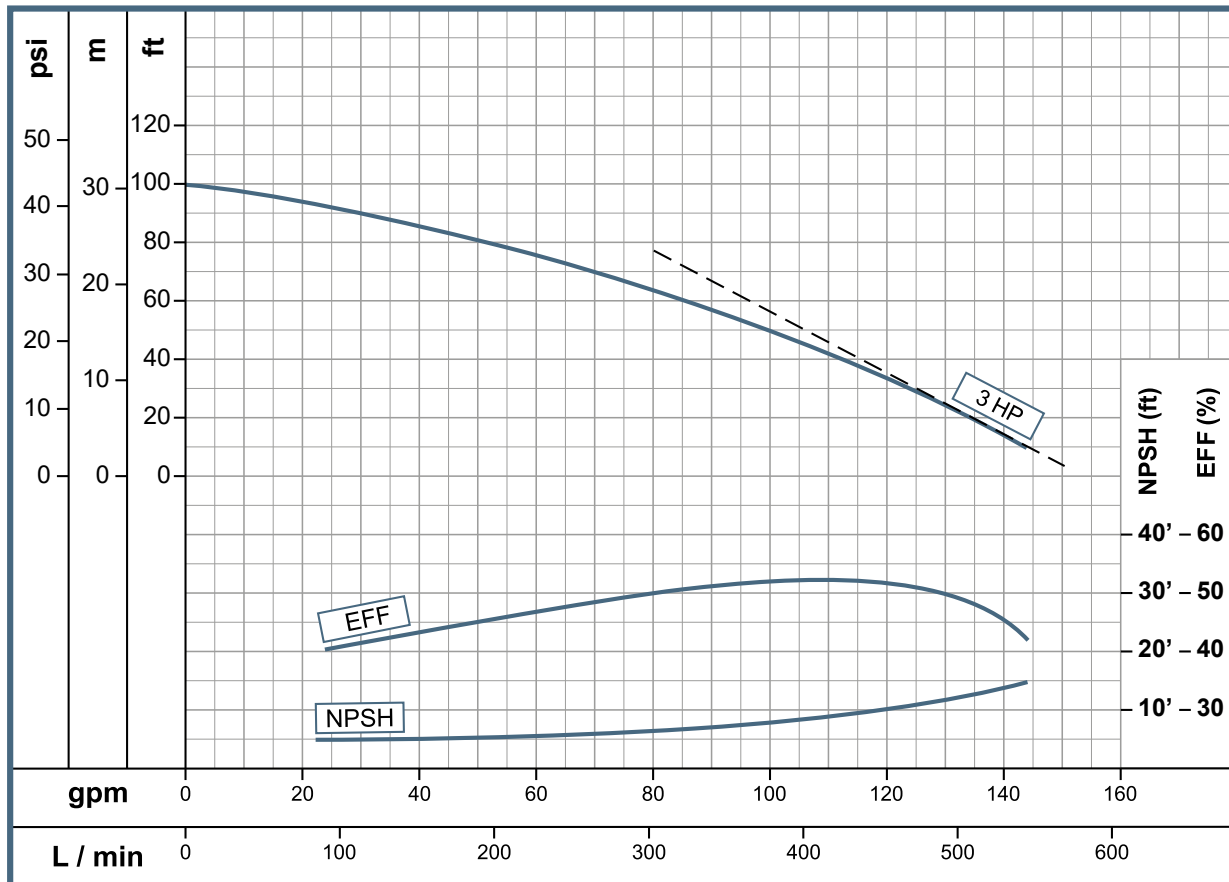

# Self-Priming Line

AE 2 30



www.wdmpumps.com

Pump Features				
Pump Type	Design		Impeller	
End Suction	Close Coupled		Semi-open (ISO G6.3)	
Stages	Mechanical Seal		Fluid Temperature	Ø Solid Handling
1	1 1/4" T01		158° F (70° C)	1/2"
Model	Reference	Ø Suction	Ø Discharge	Ø Impeller
AE 2 30	1D0501	2" NPT	2" NPT	4.875"

Motor Features				
Drive		Speed (rpm)	Frequency (Hz)	
Electric		3,600 (nominal)	60	
Power (hp)	Phases	Voltage (V)	Enclosure	Frame
3	3	230/460	TEFC	NEMA 145JM

## Performance Curve

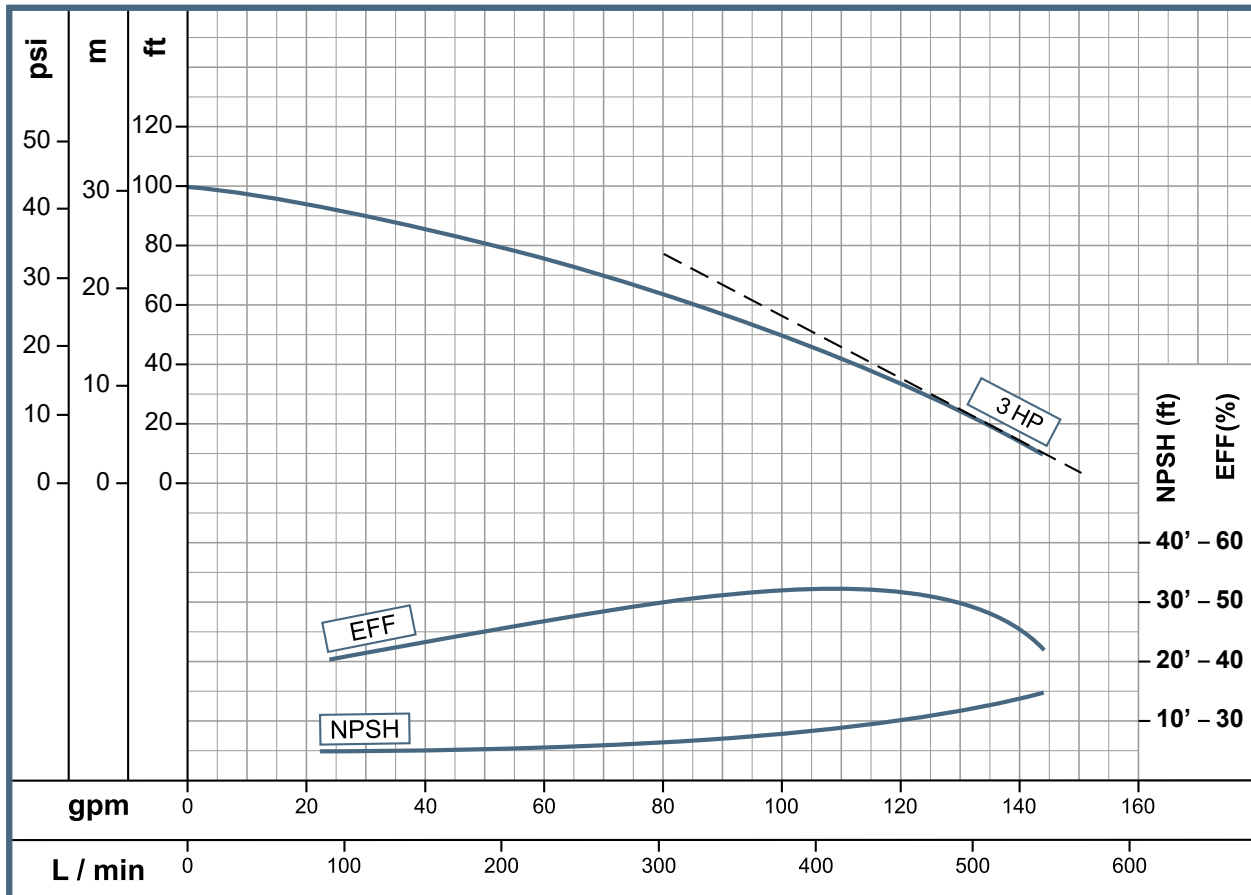

Pump Features				
Pump Type	Design		Impeller	
End Suction	Close Coupled		Semi-open (ISO G6.3)	
Stages	Mechanical Seal		Fluid Temperature	Ø Solid Handling
1	1 1/4" T01		158° F (70° C)	7/16"
Model	Reference	Ø Suction	Ø Discharge	Ø Impeller
AE 2 50	1D0502	2" NPT	2" NPT	5.500"

Motor Features				
Drive		Speed (rpm)	Frequency (Hz)	
Electric		3,600 (nominal)	60	
Power (hp)	Phases	Voltage (V)	Enclosure	Frame
5	3	230/460	TEFC	NEMA 184JM

### Performance Curve

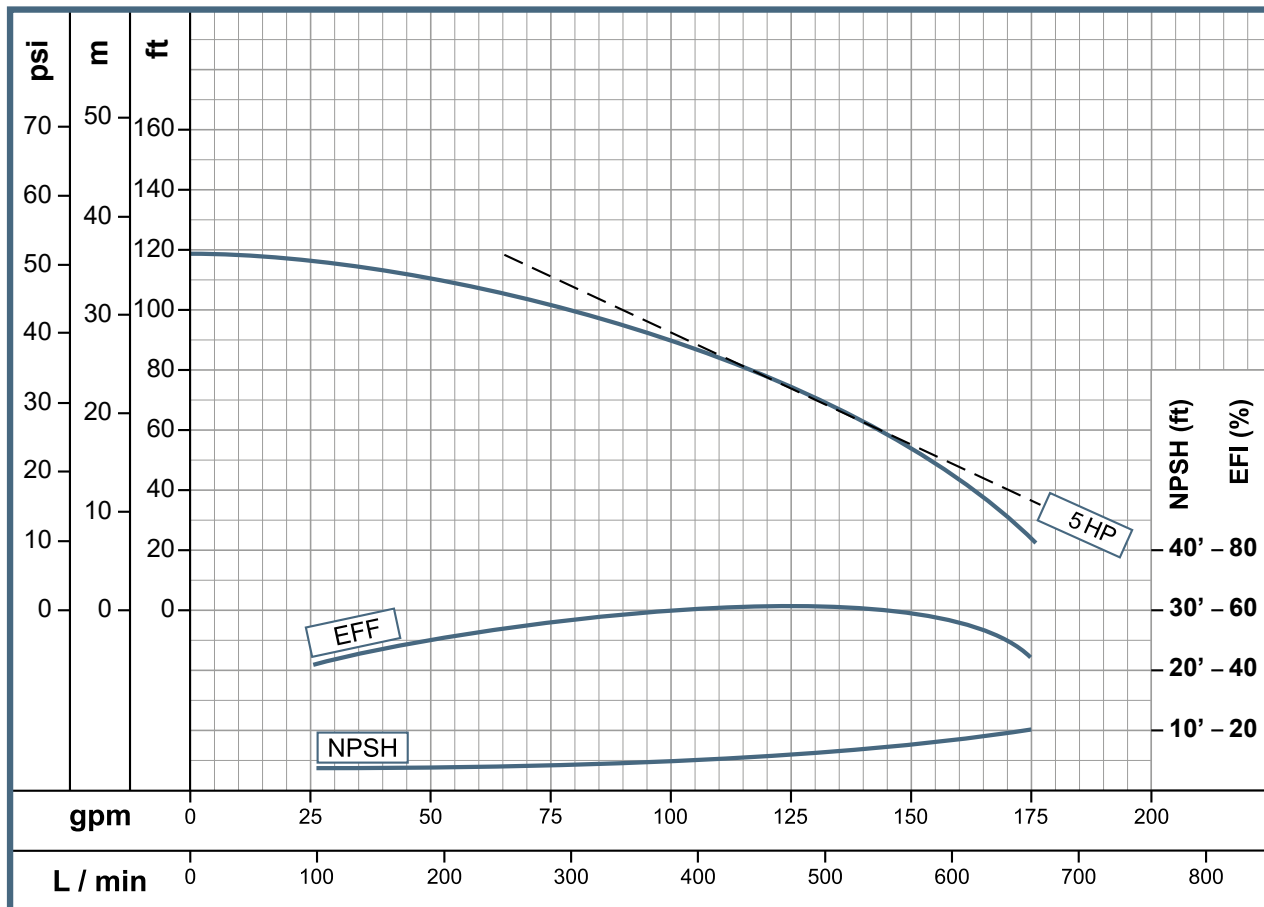

# Self-Priming Line

AE 2 75



www.wdmpumps.com

Pump Features				
Pump Type	Design		Impeller	
End Suction	Close Coupled		Semi-open (ISO G6.3)	
Stages	Mechanical Seal		Fluid Temperature	Ø Solid Handling
1	1 1/4" T01		158° F (70° C)	1/2"
Model	Reference	Ø Suction	Ø Discharge	Ø Impeller
AE 2 75	1D0383	2" NPT	2" NPT	5.500"

Motor Features				
Drive		Speed (rpm)	Frequency (Hz)	
Electric		3.600 (nominal)	60	
Power (hp)	Phases	Voltage (V)	Enclosure	Frame
7.5	3	230/460	TEFC	NEMA 184JM

## Performance Curve

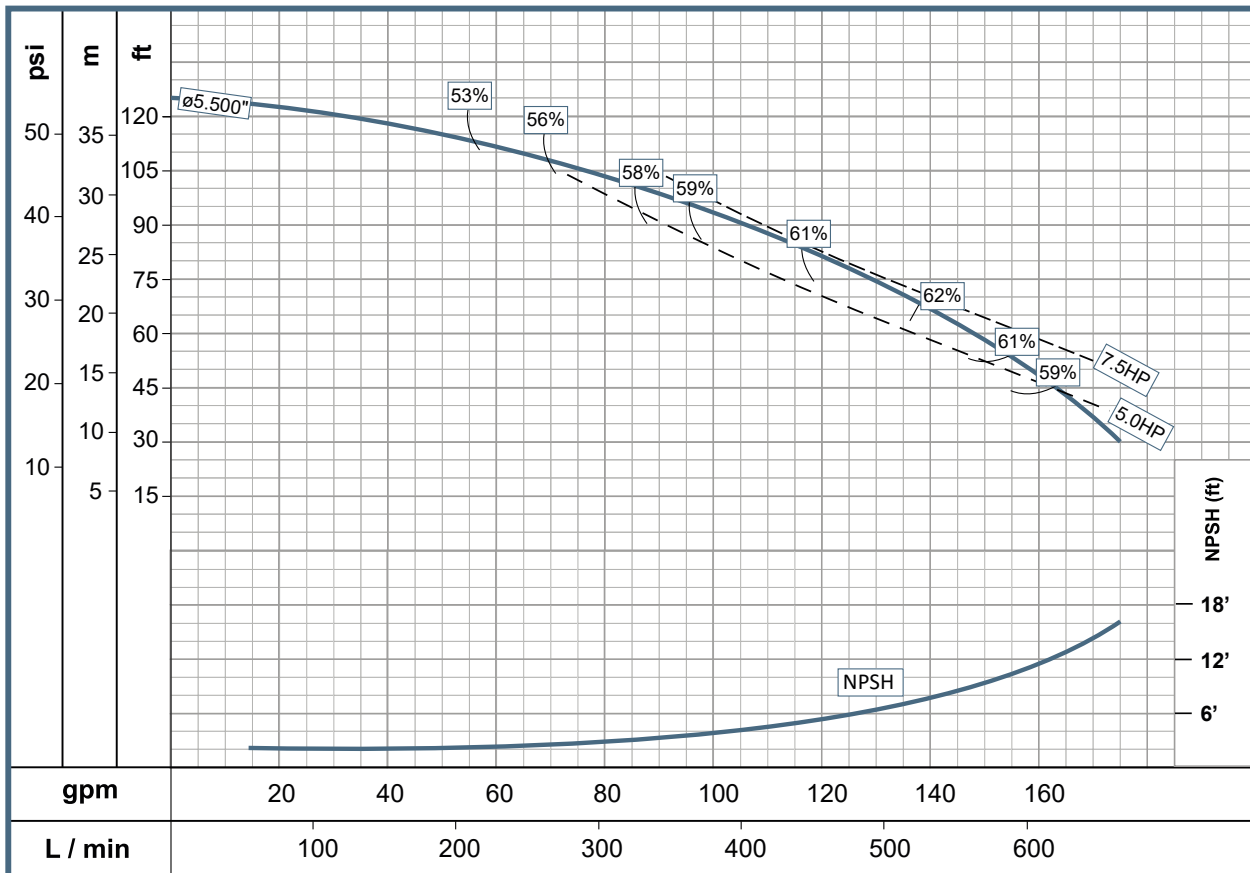

Pump Features					
Pump Type	Design		Impeller		
End Suction	Close Coupled		Semi-open (ISO G6.3)		
Stages	Mechanical Seal		Fluid Temperature	Ø Solid Handling	
1	1 1/4" T01		158° F (70° C)	1 1/16"	
Model	Reference	Ø Suction	Ø Discharge	Ø Impeller	
1	AE 3 50-1 TEFC	1D0419 / 1D0419 TC	3" NPT	3" NPT 5.500"	
2	AE 3 50	1D0385	3" NPT	3" NPT 5.500"	

Motor Features				
Drive		Speed (rpm)	Frequency (Hz)	
Electric		3.600 (nominal)	60	
Power (hp)	Phases	Voltage (V)	Enclosure	Frame
5	1	230	TEFC	NEMA 184JM
5	3	230/460	TEFC	NEMA 184JM

### Performance Curve

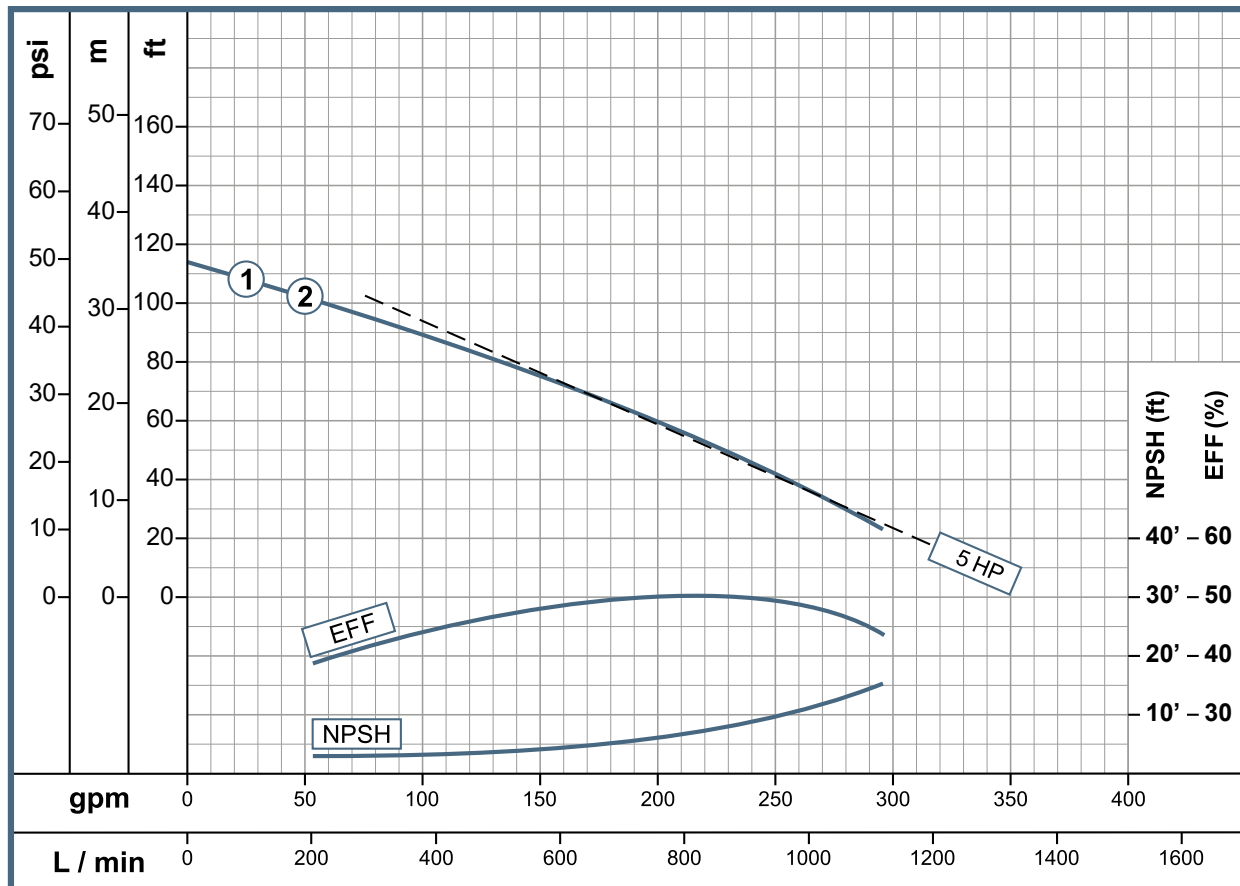

# Self-Priming Line

AE 3 75



www.wdmpumps.com

Pump Features				
Pump Type	Design		Impeller	
End Suction	Close Coupled		Semi-open (ISO G6.3)	
Stages	Mechanical Seal		Fluid Temperature	Ø Solid Handling
1	1 1/4" T01		158° F (70° C)	5/8"
Model	Reference	Ø Suction	Ø Discharge	Ø Impeller
AE 3 75	1D0505	3" NPT	3" NPT	6.000"

Motor Features				
Drive		Speed (rpm)	Frequency (Hz)	
Electric		3.600 (nominal)	60	
Power (hp)	Phases	Voltage (V)	Enclosure	Frame
7.5	3	230/460	TEFC	NEMA 184JM

## Performance Curve

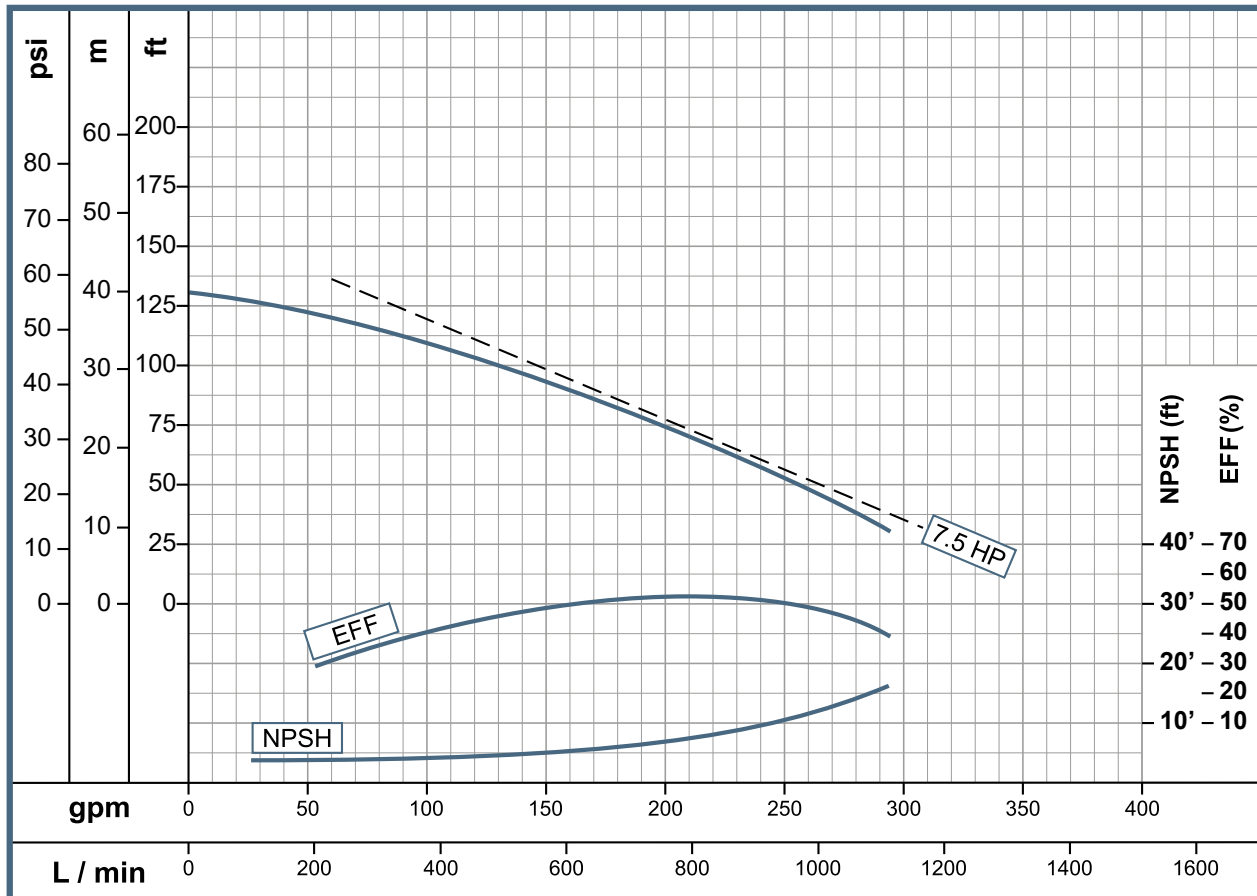

Pump Features					
Pump Type	Design		Impeller		
End Suction	Close Coupled		Semi-open (ISO G6.3)		
Stages	Mechanical Seal		Fluid Temperature	Ø Solid Handling	
1	1 1/4" T01		158° F (70° C)	11/16"	
Model	Reference	Ø Suction	Ø Discharge	Ø Impeller	
1	AE 4 100	1D0506	4" NPT	6.000"	
2	AE 4 150	1D0507	4" NPT	7.000"	

Motor Features				
Drive		Speed (rpm)	Frequency (Hz)	
Electric		3,600 (nominal)	60	
Power (hp)	Phases	Voltage (V)	Enclosure	Frame
10	3	230/460	TEFC	NEMA 215JM
15	3	230/460	TEFC	NEMA 215JM

### Performance Curve

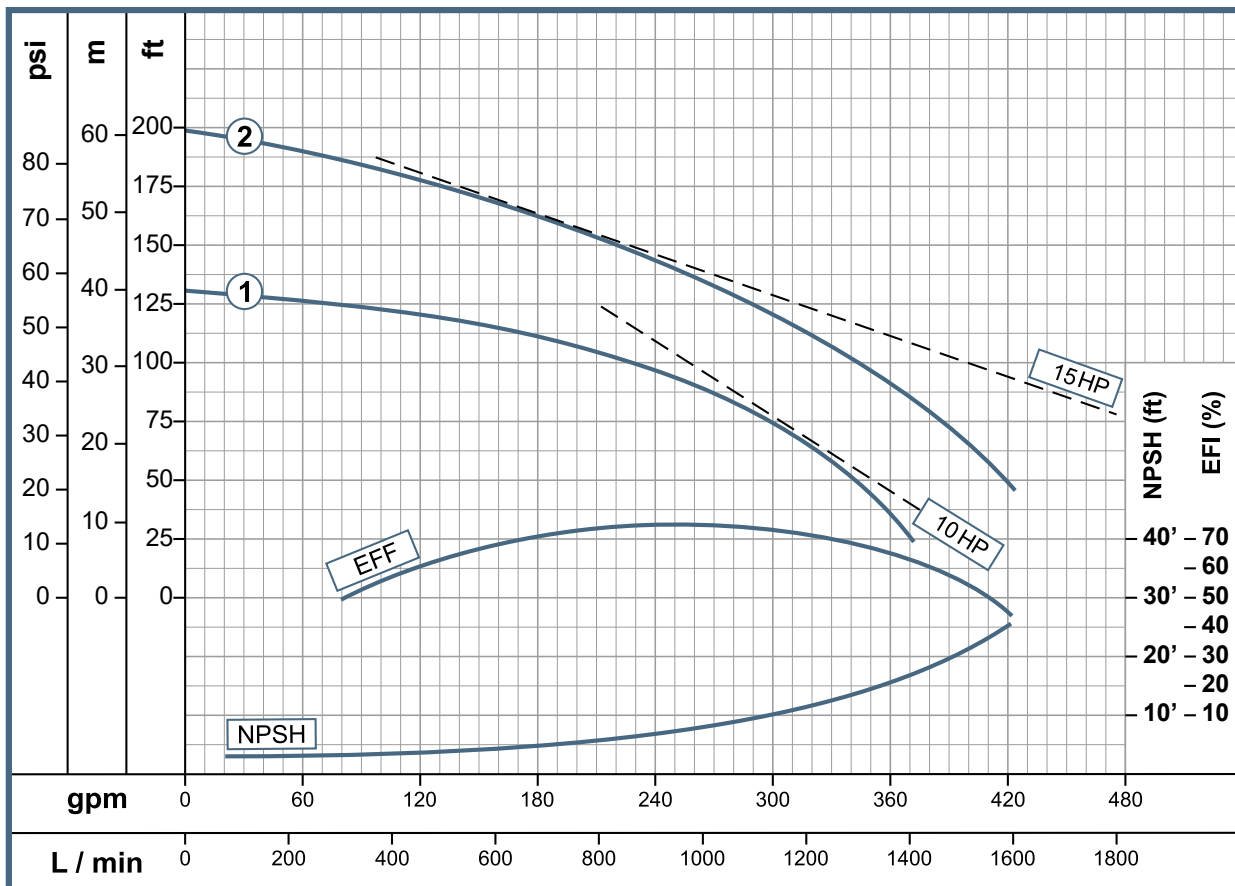

# Self-Priming Line

AE 6B 100-1  
 AE 6B 100  
 AE 6B 150



www.wdmpumps.com

Pump Features					
Pump Type	Design		Impeller		
End Suction	Close Coupled		Semi-open (ISO G6.3)		
Stages	Mechanical Seal		Fluid Temperature	Ø Solid Handling	
1	1 1/4" T21		158° F (70° C)	41/64"	
Model	Reference	Ø Suction	Ø Discharge	Ø Impeller	
1	AE 6B 100-1	1D0549	6" NPT	5.000"	
2	AE 6B 100	1D0550	6" NPT	5.000"	
3	AE 6B 150	1D0551	6" NPT	5.500"	

Motor Features				
Drive		Speed (rpm)	Frequency (Hz)	
Electric		3,600 (nominal)	60	
Power (hp)	Phases	Voltage (V)	Enclosure	Frame
10	1	230	ODP	NEMA 256JM
10	3	230/460	TEFC	NEMA 256JM
15	3	230/460	TEFC	NEMA 256JM

## Performance Curve

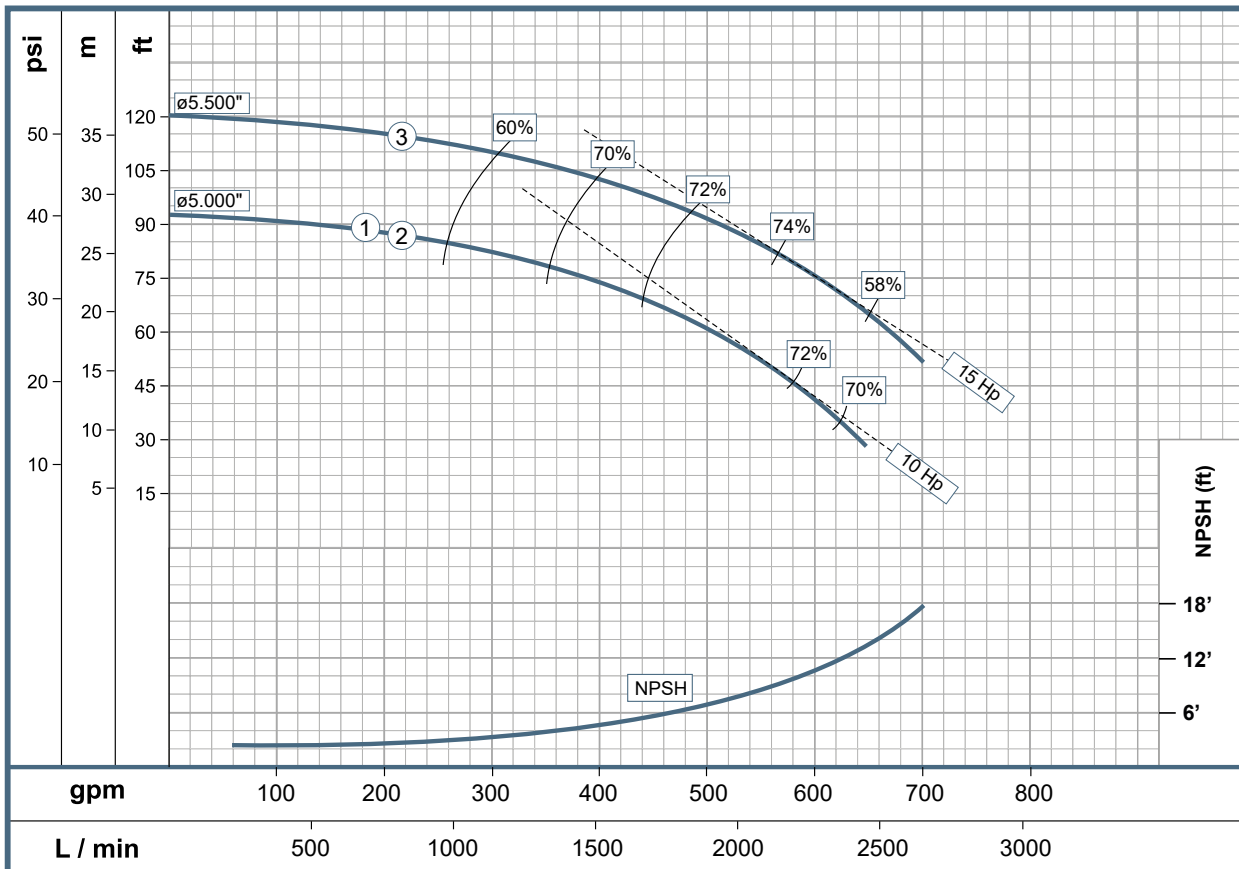

Pump Features				
Pump Type	Design		Impeller	
End Suction	Close Coupled		Semi-open (ISO G6.3)	
Stages	Mechanical Seal		Fluid Temperature	Ø Solid Handling
1	1 1/2" T21		158° F (70° C)	1 1/4"
Model	Reference	Ø Suction	Ø Discharge	Ø Impeller
AE 6R 250	1D0511P	6" NPT	6" NPT	6.000"

Motor Features				
Drive		Speed (rpm)	Frequency (Hz)	
Electric		3,600 (nominal)	60	
Power (hp)	Phases	Voltage (V)	Enclosure	Frame
25	3	230/460	TEFC	NEMA 256JM

### Performance Curve

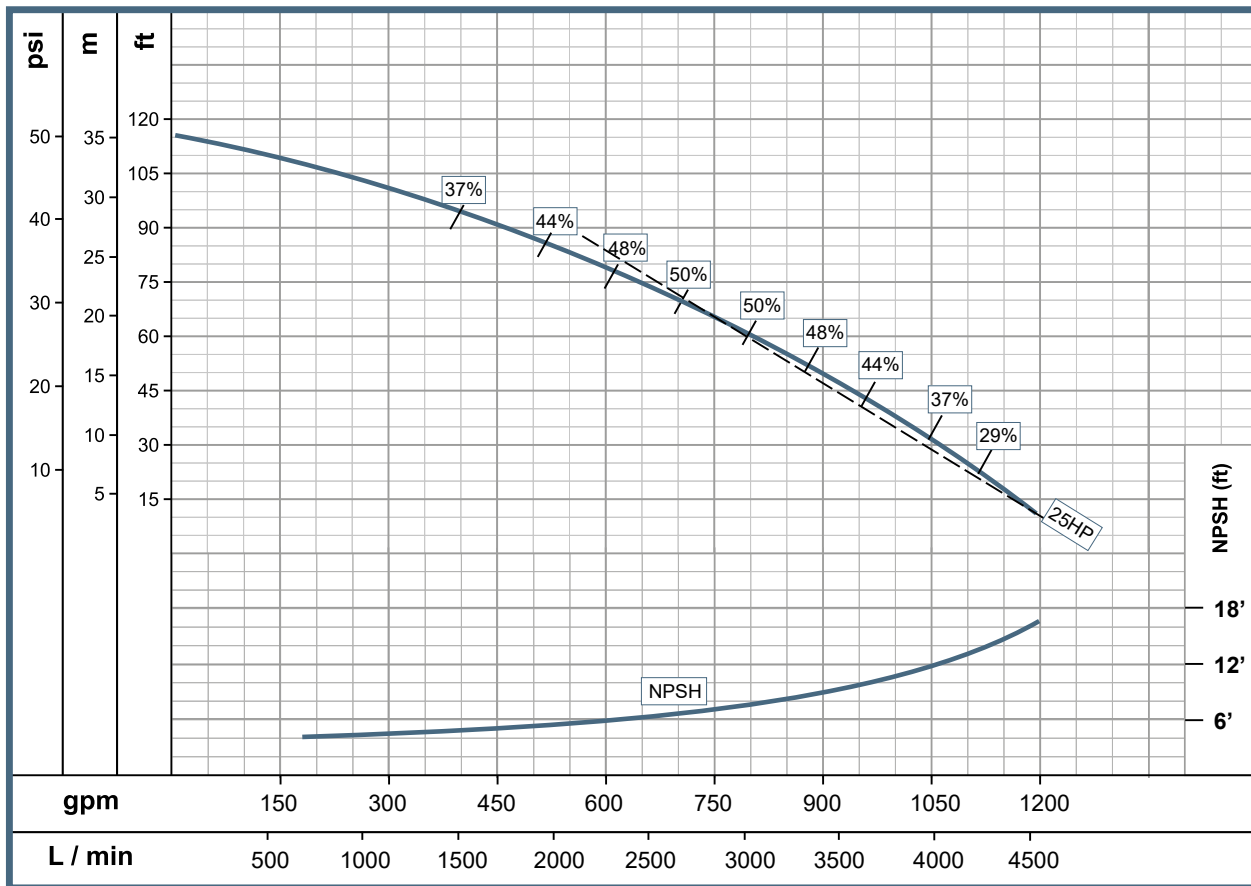

# Self-Priming Line

AU 1.5  
Frame Mounted  
Pumps



www.wdmpumps.com

Pump Features				
Pump Type	Design		Impeller	
End Suction	Universal		Semi-open (ISO G6.3)	
Stages	Mechanical Seal		Fluid Temperature	Ø Solid Handling
1	1 1/4" T01		158° F (70° C)	3/8"
Model	Reference	Ø Suction	Ø Discharge	Ø Impeller
AU 1.5	1D0017	1 1/2" NPT	1 1/2" NPT	4.875"

## Performance Curve

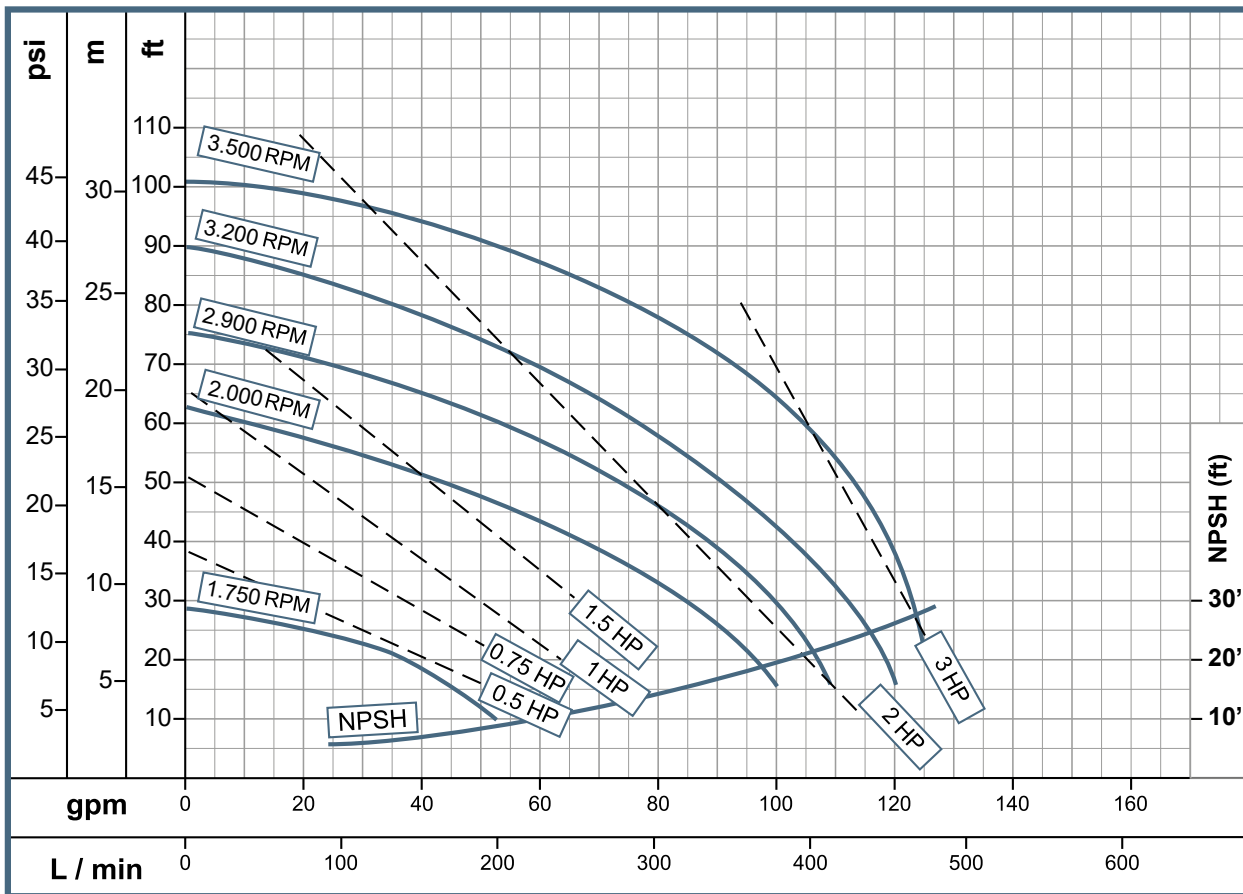

Pump Features				
Pump Type	Design		Impeller	
End Suction	Universal		Semi-open (ISO G6.3)	
Stages	Mechanical Seal		Fluid Temperature	Ø Solid Handling
1	1 1/4" T01		158° F (70° C)	7/16"
Model	Reference	Ø Suction	Ø Discharge	Ø Impeller
AU 2M	1D0018	2" NPT	2" NPT	4.875"

### Performance Curve

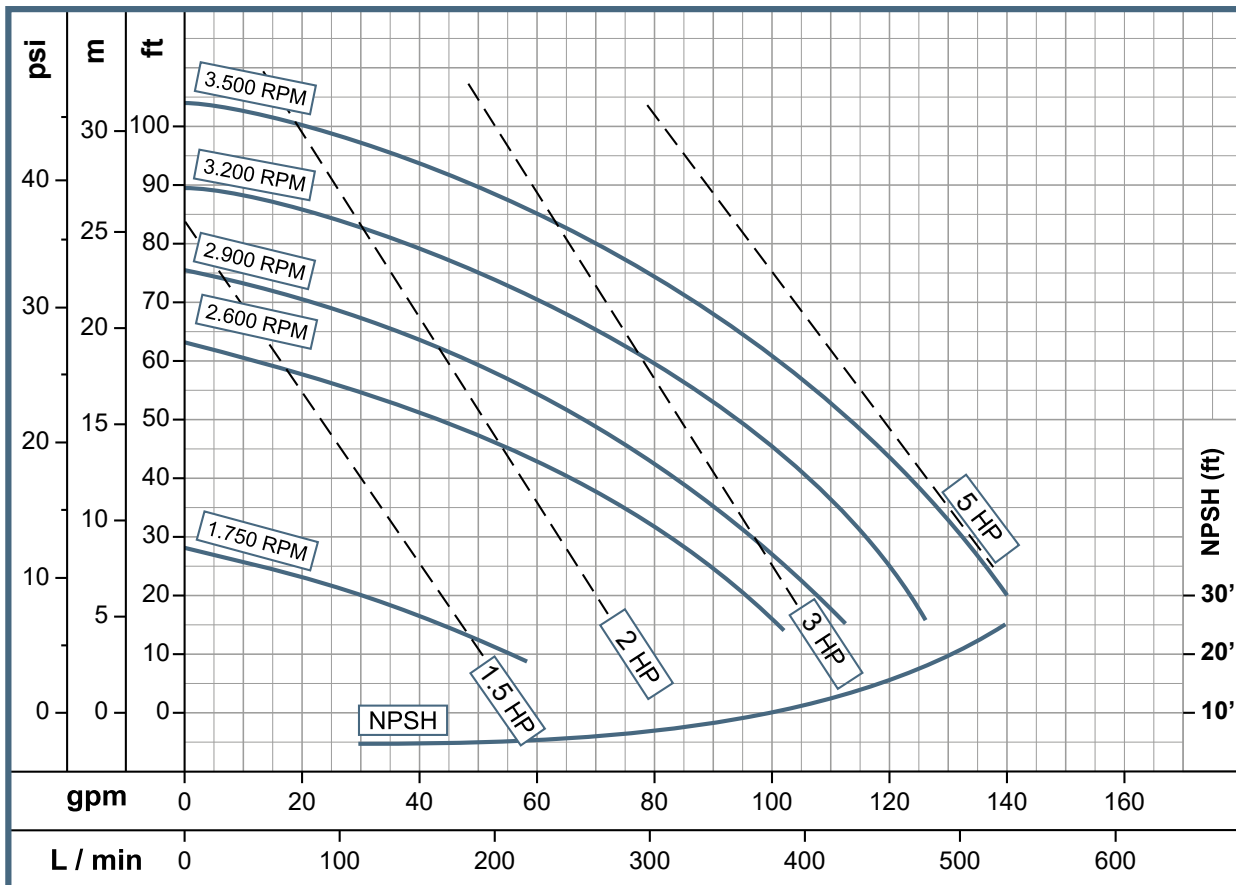

# Self-Priming Line

AU 2N  
Frame Mounted  
Pumps



www.wdmpumps.com

Pump Features				
Pump Type	Design		Impeller	
End Suction	Universal		Semi-open (ISO G6.3)	
Stages	Mechanical Seal		Fluid Temperature	Ø Solid Handling
1	1 1/4" T01		158° F (70° C)	7/16"
Model	Reference	Ø Suction	Ø Discharge	Ø Impeller
AU 2N	1D0019	2" NPT	2" NPT	5.500"

## Performance Curve

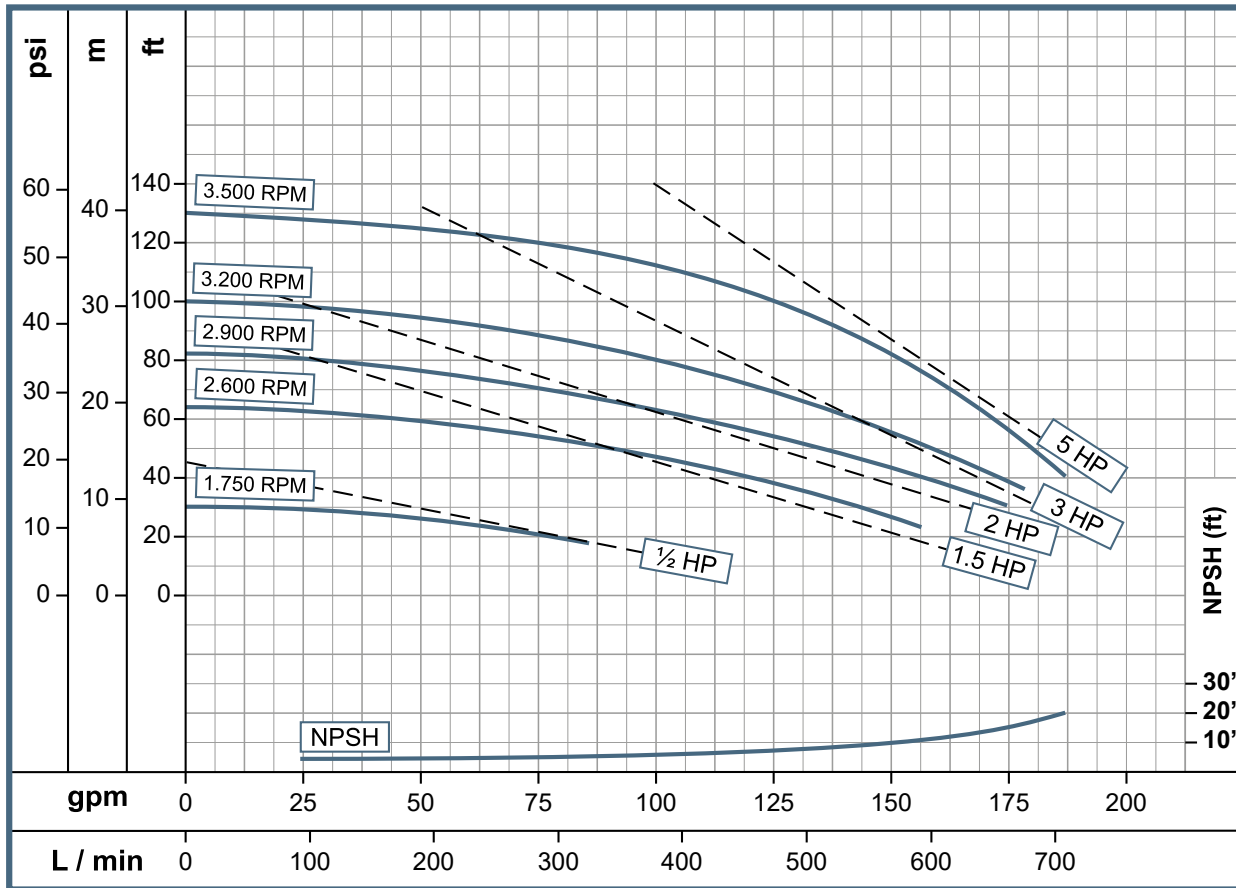

Pump Features				
Pump Type	Design		Impeller	
End Suction	Universal		Semi-open (ISO G6.3)	
Stages	Mechanical Seal		Fluid Temperature	Ø Solid Handling
1	1 1/4" T01		158° F (70° C)	3/4"
Model	Reference	Ø Suction	Ø Discharge	Ø Impeller
AU 3	1D0021	3" NPT	3" NPT	6.000"

### Performance Curve

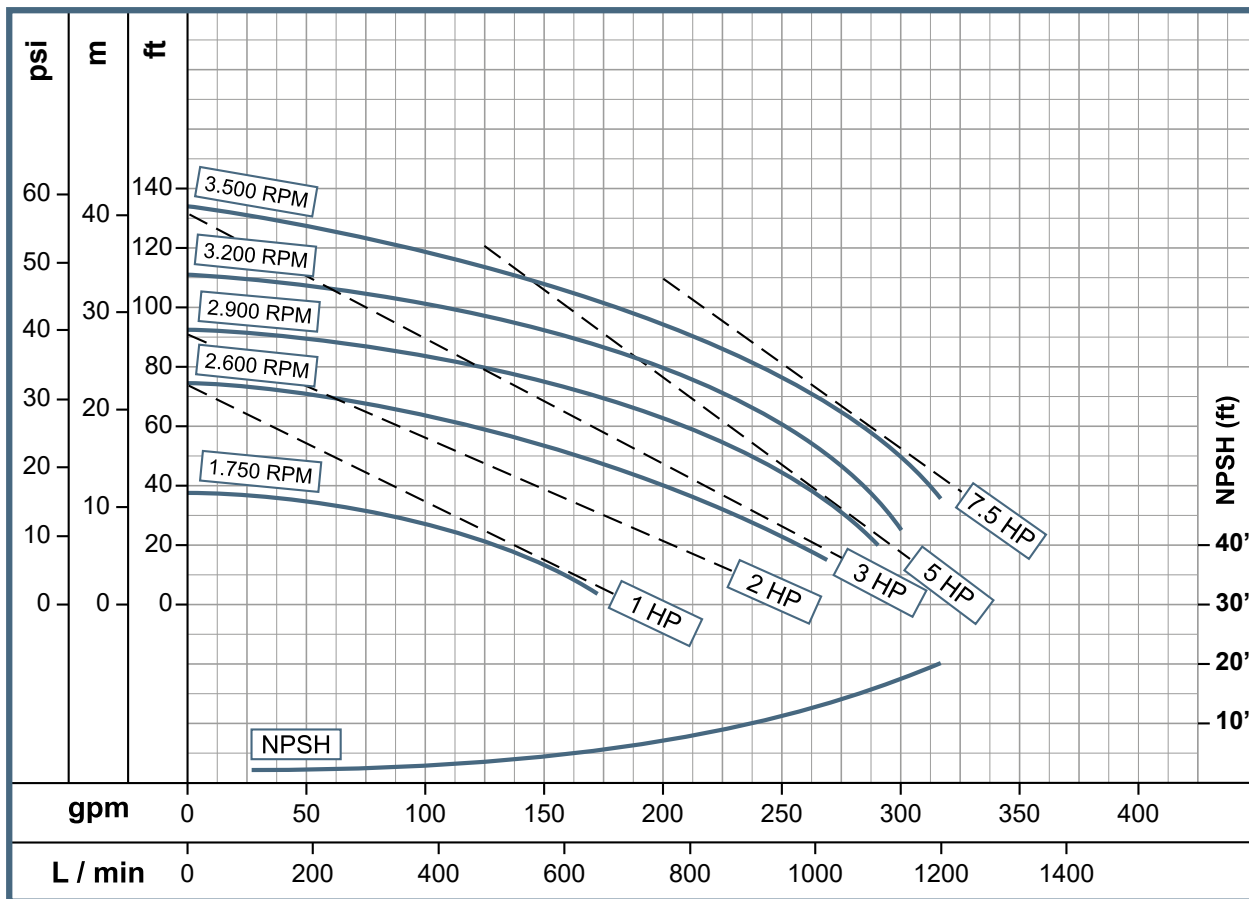

# Self-Priming Line

AU 4  
Frame Mounted  
Pumps



www.wdmpumps.com

Pump Features				
Pump Type	Design		Impeller	
End Suction	Universal		Semi-open (ISO G6.3)	
Stages	Mechanical Seal		Fluid Temperature	Ø Solid Handling
1	1 1/4" T01		158° F (70° C)	11/16"
Model	Reference	Ø Suction	Ø Discharge	Ø Impeller
AU 4	1D0022	4" NPT	4" NPT	7.000"

## Performance Curve

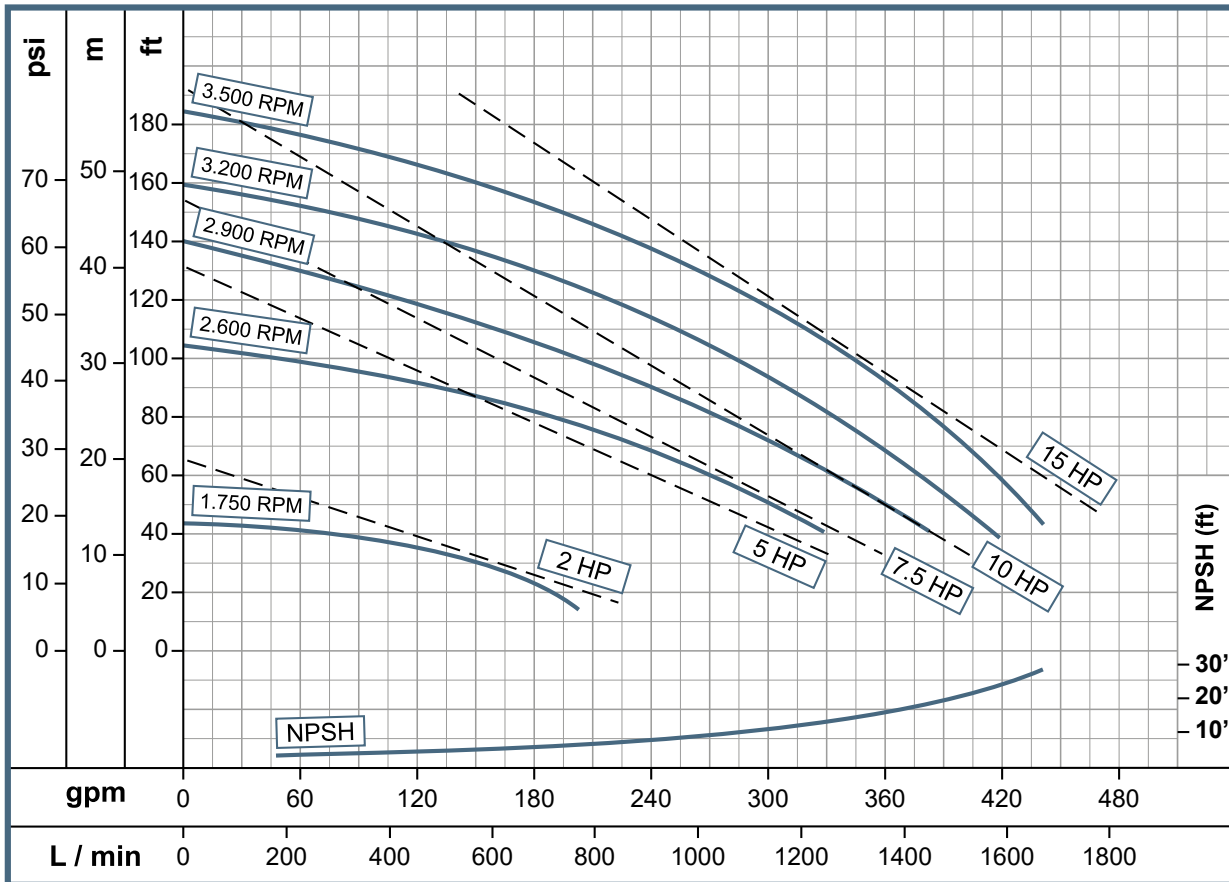

Pump Features				
Pump Type	Design		Impeller	
End Suction	Universal		Semi-open (ISO G6.3)	
Stages	Mechanical Seal		Fluid Temperature	Ø Solid Handling
1	1 1/2" T21		158° F (70° C)	1 5/8"
Model	Reference	Ø Suction	Ø Discharge	Ø Impeller
AU 6	1D0023	6" NPT	6" NPT	10.375"

### Performance Curve

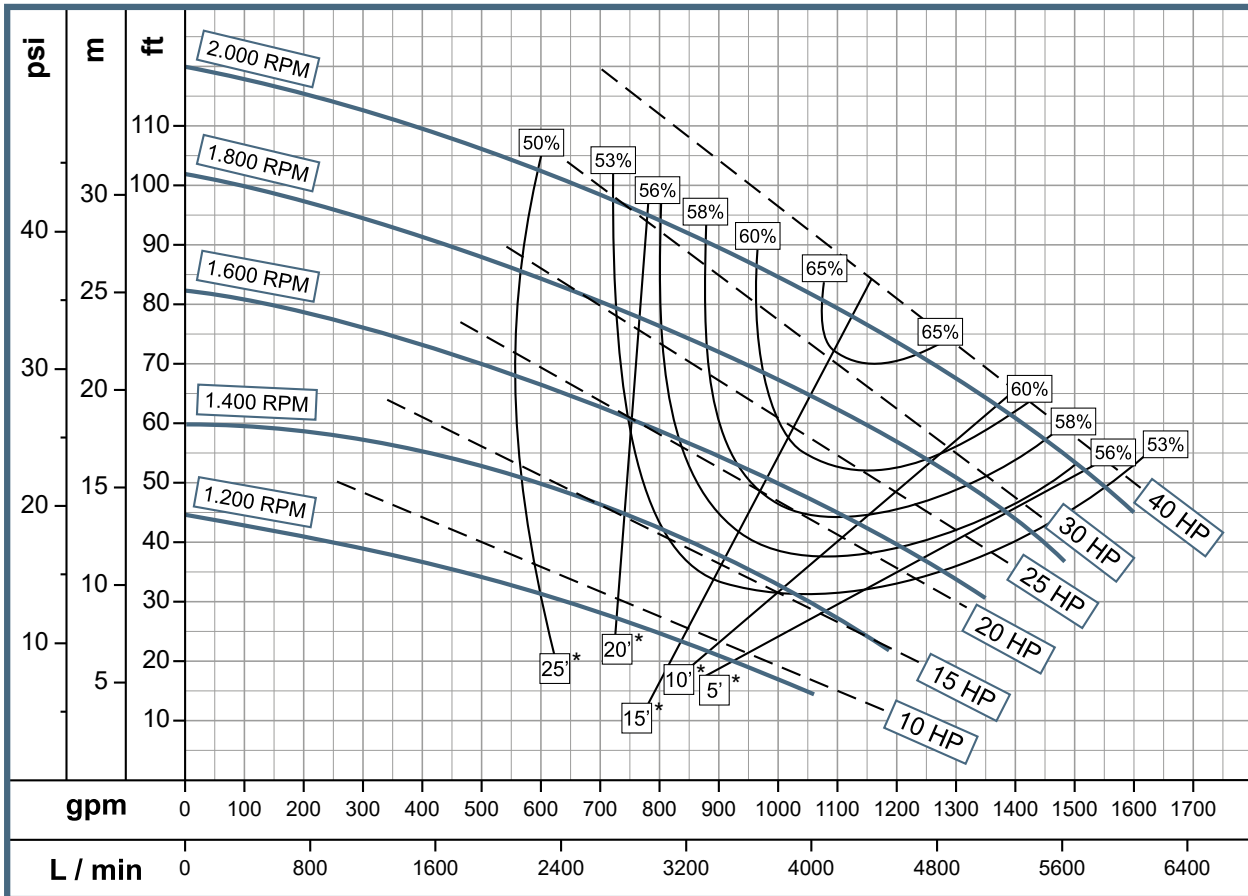

# Self-Priming Line

AU 6R  
Frame Mounted  
Pumps



www.wdmpumps.com

Pump Features				
Pump Type	Design		Impeller	
End Suction	Universal		Closed (ISO G6.3)	
Stages	Mechanical Seal		Fluid Temperature	Ø Solid Handling
1	1 3/4" T21		158° F (70° C)	1 1/4"
Model	Reference	Ø Suction	Ø Discharge	Ø Impeller
AU 6R	1D0513	6" NPT	6" NPT	6.000"

## Performance Curve

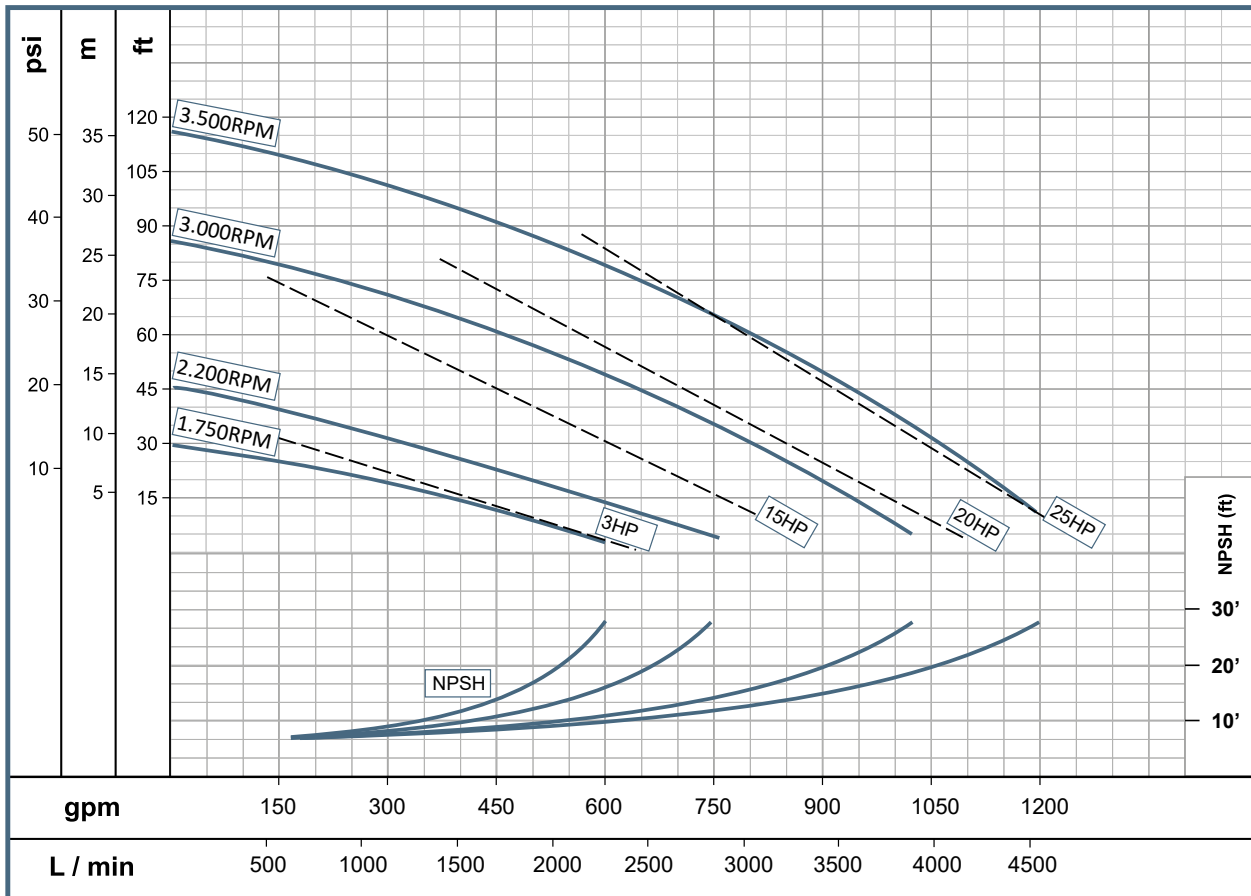

Pump Features				
Pump Type	Design		Impeller	
End Suction	Universal		Semi-open (ISO G6.3)	
Stages	Mechanical Seal		Fluid Temperature	Ø Solid Handling
1	1 1/2" T21		158° F (70° C)	1 5/8"
Model	Reference	Ø Suction	Ø Discharge	Ø Impeller
AU 8	1D0125	8"	8"	10.375"

### Performance Curve

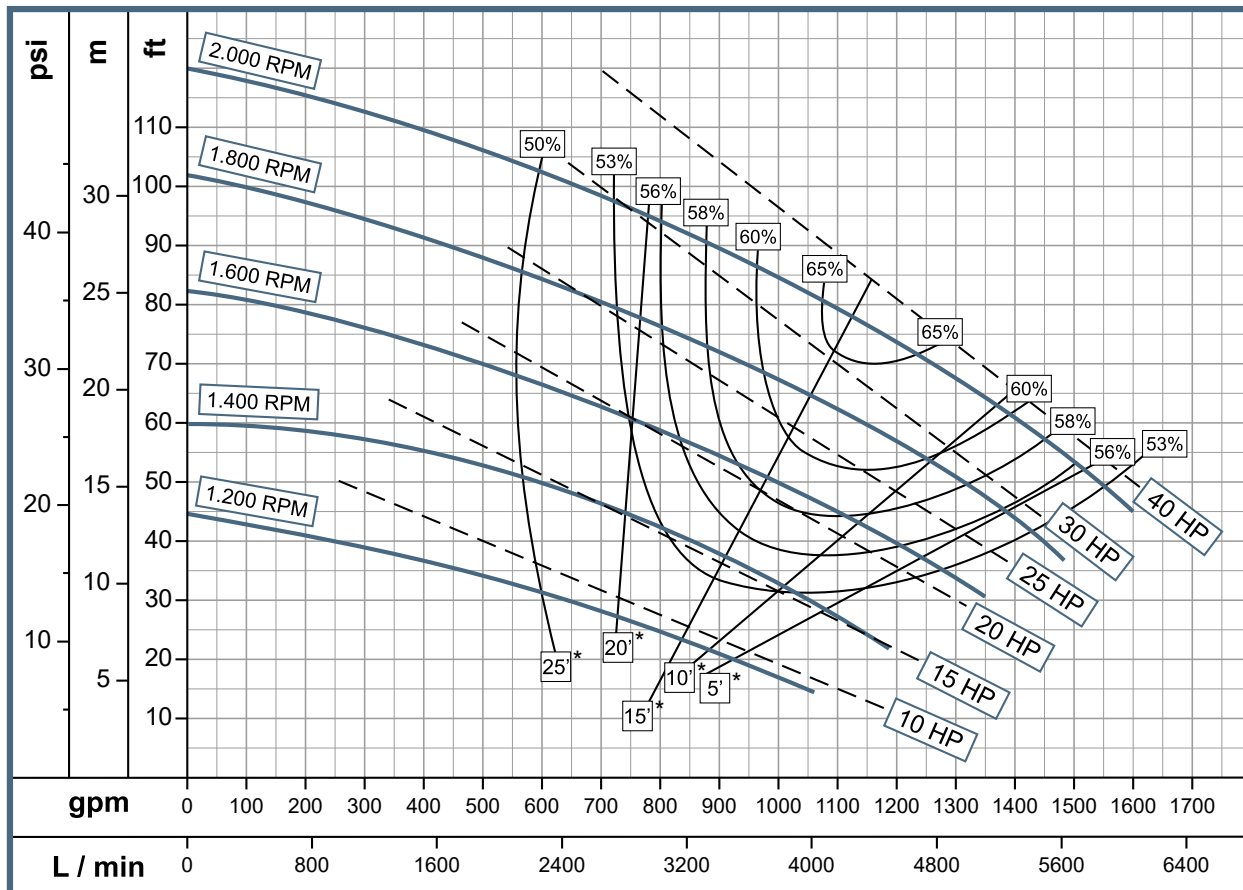

# Self-Priming Line

AU 10  
Frame Mounted  
Pumps



www.wdmpumps.com

Pump Features					
Pump Type	Design		Impeller		
End Suction	Universal		Semi-open (ISO G6.3)		
Stages	Mechanical Seal		Fluid Temperature	Ø Solid Handling	
1	2 1/8" T21		158° F (70° C)	2.5"	
Model	Reference	Ø Suction	Ø Discharge	Ø Impeller	
1	AU 10	1D0024	10" NPT	10" NPT	11.937"

## Performance Curve

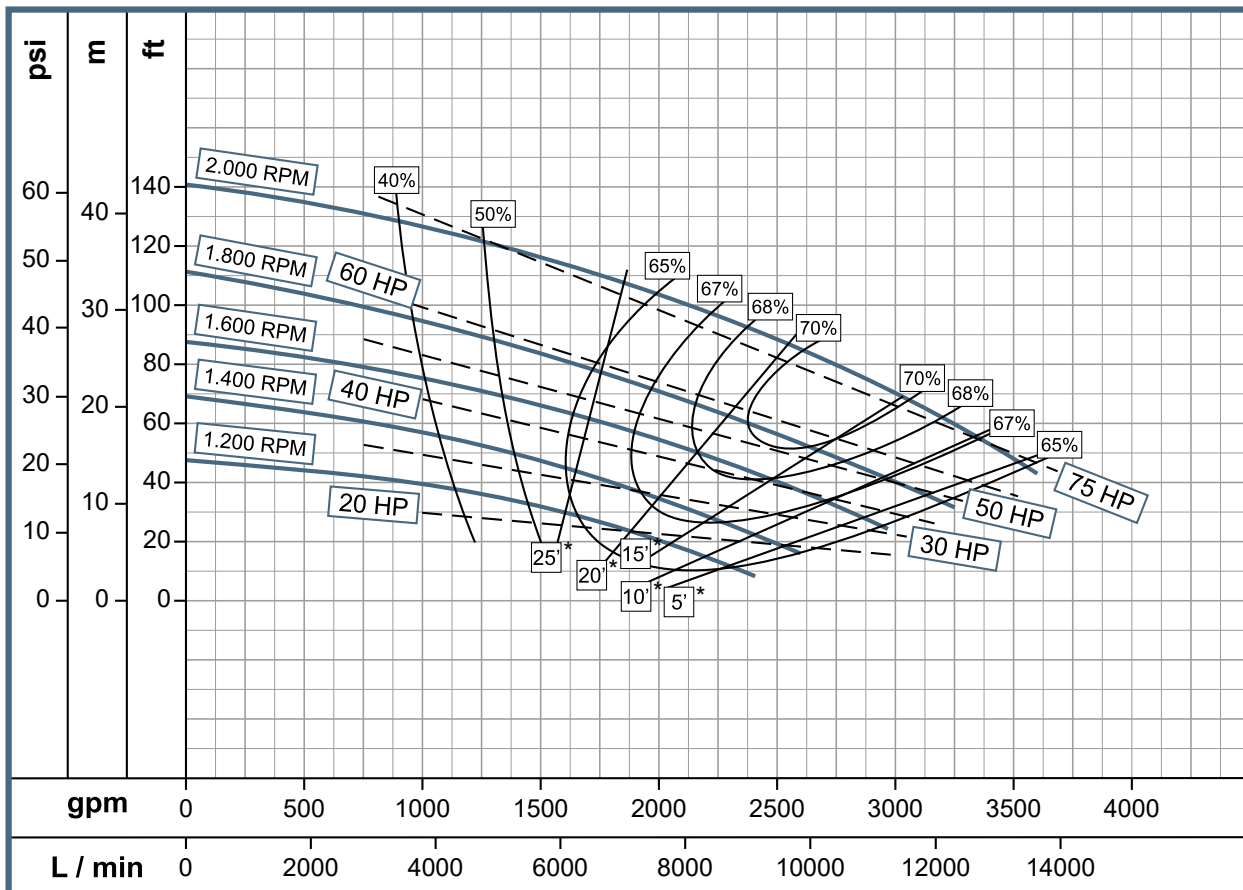

[www.wdmpumps.com](http://www.wdmpumps.com)



■ [www.wdmpumps.com](http://www.wdmpumps.com)

VERSIÓN	1
FECHA	27/06/24